

## English

## YA-F10/YA-F20

## User's Guide

- Be sure to keep all user documentation handy for future reference.
- To obtain the latest version of this manual visit the website at the URL below. Other language versions of the manual are also available at the same website.  
<http://world.casio.com/manual/projector/>

## Introduction

This product is designed for exclusive use with a CASIO projector (XJ-A Series or XJ-M Series). Attaching it to the projector's intake vent will reduce the amount of dust that gets into the projector.



- The contents of this User's Guide are subject to change without notice.
- Copying of this manual, either in part or its entirety, is forbidden. You are allowed to use this manual for your own personal use. Any other use is forbidden without the permission of CASIO COMPUTER CO., LTD.
- CASIO COMPUTER CO., LTD. shall not be held liable for any lost profits or claims from third parties arising out of the use of this product or this manual.
- CASIO COMPUTER CO., LTD. shall not be held liable for any loss or lost profits due to loss of data caused by malfunction or maintenance of this product, or any other reason.

## Safety Precautions

Thank you for selecting this CASIO product. Be sure to read these "Safety Precautions" before trying to use it.

## About safety symbols

The symbol described below is used in the User's Guide and on the product itself to ensure safe use, and to protect you and others against the risk of injury and against material damage.

 <b>Warning</b>
This symbol indicates information that, if ignored or applied incorrectly, could possibly create the risk of death or serious personal injury.

A circle with a line through it indicates information about an action that you should not perform. The specific action is indicated by the figure inside the circle. The example shown here means disassembly is prohibited.

**Warning**

## ● Disassembly and modification

-  Never try to take the projector apart or modify it in any way. Doing so creates the risk of personal injury and damage to the product.

## ● Disposal by burning

-  Never try to dispose of the projector by burning it. Doing so creates the risk of fire and personal injury.

## Operating Precautions

- Before attaching this filter, be sure to turn off the projector.
- When attaching or detaching the dust filter, make sure it is oriented correctly and do not apply undue force.
- After attaching the filter, clean it periodically.

## To attach a YA-F10 filter to an XJ-A Series projector

1. Disconnect the power cable from the projector.
2. Pull out the left rear foot of the projector as far as it will go.
3. Slide the filter straight into the side of the projector.

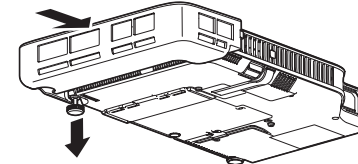

4. Slide the lock switch in the direction of the arrow to lock the filter in place.

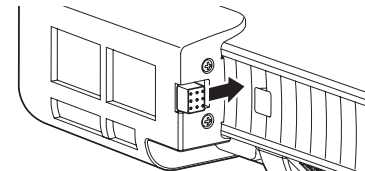

5. Return the rear foot to its original position.

## To attach a YA-F20 filter to an XJ-M Series projector

1. Disconnect the power cable from the projector.
2. Slide the filter straight into the side of the projector.

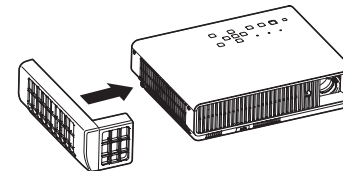

3. If the projector is ceiling mounted, pass the power cord through the safety strap when you re-connect it.

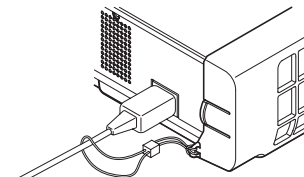

## To remove the filter from the projector

1. Disconnect the power cable from the projector.
2. Perform the installation steps (above) in reverse.
  - Pull the filter straight out of the projector.

## Cleaning the Filter

**Important!**

- Continued use of the projector after dust has accumulated around its intake vents or in the filter can cause overheating of internal projector components, which can lead to loss of projection brightness and malfunction. Use a vacuum cleaner to carefully clean dust from the projector's intake vents and the filter.
- Vacuum the filter from the outside. Strong vacuuming power inside the filter can cause components to become detached.
- If cleaning cannot remove all of the dirt and dust from the filter, replace it with a new YA-F10 or YA-F20.
- Do not wash the filter in water. Doing so will cause a loss of filter performance.

Use a vacuum cleaner to carefully clean dust from the filter.

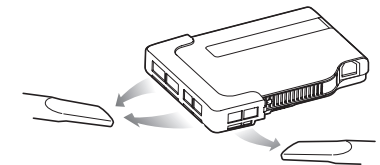

YA-F10 (XJ-A Series)

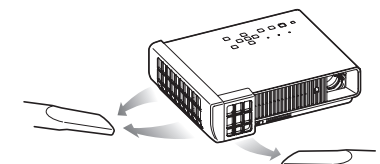

YA-F20 (XJ-M Series)

- For information about how to clean the projector, see its user's guide.

## Free Manuals Download Website

<http://myh66.com>

<http://usermanuals.us>

<http://www.somanuals.com>

<http://www.4manuals.cc>

<http://www.manual-lib.com>

<http://www.404manual.com>

<http://www.luxmanual.com>

<http://aubethermostatmanual.com>

Golf course search by state

<http://golfingnear.com>

Email search by domain

<http://emailbydomain.com>

Auto manuals search

<http://auto.somanuals.com>

TV manuals search

<http://tv.somanuals.com>