

Register your product and get support at  
[www.philips.com/welcome](http://www.philips.com/welcome)

# Bluetooth stereo headset

SHB6000/00

SHB6000/28



EN

User manual

# PHILIPS

# Contents

---

<b>1</b>	<b>Important</b>	<b>2</b>
	Hearing Safety	2
	Electric-, Magnetic- and Electromagnetic Fields (EMF)	2
	General information	2
	Disposal of your old product	2
	Battery disposal	2
	Remove the integrated battery	2
	Notice for the European Union	3
	Notice for USA (FCC)	3
	Notice for Canada	3
	Trademarks	3

---

<b>2</b>	<b>Your bluetooth stereo headset</b>	<b>4</b>
	Introduction	4
	What's in the box	4
	Compatibility	4
	Overview of your Bluetooth stereo headset	5

---

<b>3</b>	<b>Get started</b>	<b>6</b>
	Charge the headset	6
	Pair the headset with your mobile phone	6

---

<b>4</b>	<b>Use the headset</b>	<b>7</b>
	Connect the headset to your mobile phone	7
	Automatic power saving	7
	Get the best fit	7
	Operate the headset	7
	Manage 3-way calls	7
	LED and sound indication	7
	Clean the headset	7

---

<b>5</b>	<b>Technical data</b>	<b>8</b>
----------	-----------------------	----------

---

<b>6</b>	<b>Frequently asked questions</b>	<b>9</b>
----------	-----------------------------------	----------

# 1 Important

## Hearing Safety



### Danger

- To avoid hearing damage, limit the time you use the headphones at high volume and set the volume to a safe level. The louder the volume, the shorter is the safe listening time.

### Be sure to observe the following guidelines when using your headphones.

- Listen at reasonable volumes for reasonable periods of time.
- Be careful not to adjust the volume continuously upwards as your hearing adapts.
- Do not turn up the volume so high that you can't hear what's around you.
- You should use caution or temporarily discontinue use in potentially hazardous situations.
- Excessive sound pressure from earphones and headphones can cause hearing loss.
- Using this headset with both ears covered while driving is not recommended and may be illegal in some areas while driving.
- For your safety, avoid distractions from music or phone calls while in traffic or other potentially dangerous environments.

## Electric-, Magnetic- and Electromagnetic Fields (EMF)

1. Royal Philips Electronics manufactures and sells many products targeted at consumers, which, like any electronic apparatus, in general have the ability to emit and receive electromagnetic signals.
2. One of Philips' leading Business Principles is to take all necessary health and safety measures for our products, to comply with all applicable legal requirements and to stay well within the EMF standards applicable at the time of producing products.
3. Philips is committed to develop, produce and market products that cause no adverse health effects.
4. Philips confirms that if its products are handled properly for their intended use, they are safe to use according to scientific evidence available today.
5. Philips plays an active role in the development of international EMF and safety standards, enabling Philips to anticipate further developments in standardization for early integration in its products.

## General information

### To avoid damage or malfunction:

- Do not expose the headset to excessive heat.
- Do not drop your headset.
- The headset can be washable under running tap water while the charging socket shall not be exposed to dripping or splashing.
- Do not allow your headset to be submerged in water.
- Do not use any cleaning agents containing alcohol, ammonia, benzene, or abrasives.

### About operating and storage temperatures

- Do not operate or store in a place where temperature is below -15°C (5°F) or above 55°C (131°F) as this may shorten your battery life.

- The integrated battery shall not be exposed to excessive heat such as sunshine, fire or the like.
- Ensure that there is no foreign objects inside the USB cover and close the cover tightly.

## Disposal of your old product

Your product is designed and manufactured with high quality materials and components, which can be recycled and reused.



When this crossed-out wheeled bin symbol is attached to a product it means that the product is covered by the European Directive 2002/96/EC.

Please inform yourself about the local separate collection system for electrical and electronic products. Please act according to your local rules and do not dispose of your old products with your normal household waste. Correct disposal of your old product helps to prevent potential negative consequences for the environment and human health.

## Battery disposal

Your product contains batteries covered by the European Directive 2006/66/EC, which cannot be disposed of with normal household waste.



Please inform yourself about the local rules on separate collection of batteries. The correct disposal of batteries helps prevent potentially negative consequences on the environment and human health.

## Remove the integrated battery

### Warning

- Make sure the headset is disconnected from the USB charging cable before removing the battery.

If there is no collection/recycling system for electronic products in your country, you can protect the environment by removing and recycling the battery before disposing the headset.

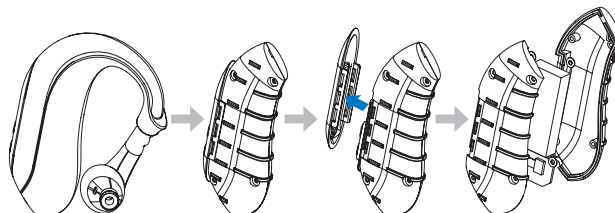

## Notice for the European Union



Hereby, Philips Consumer Lifestyle, BG Accessories, declares that this Philips Bluetooth headset SHB6000 is in compliance with the essential requirements and other relevant provisions of Directive 1999/5/EC. This product has been designed, tested and manufactured according to the European R&TTE Directive 1999/5/EC.

## Notice for USA (FCC)

This device complies with Part 15 of the FCC Rules. Operation is subject to the following two conditions: (1) this device may not cause harmful interference, and (2) this device must accept any interference received, including interference that may cause undesired operation. This equipment has been tested and found to comply with the limits for a Class B digital device, pursuant to part 15 of the FCC Rules. These limits are designed to provide reasonable protection against harmful interference in a residential installation. This equipment generates, uses and can radiate radio frequency energy and, if not installed and used in accordance with the instruction manual, may cause harmful interference to radio communications. However, there is no guarantee that interference will not occur in a particular installation. If this equipment does cause harmful interference to radio or television reception, which can be determined by turning the equipment off and on, the user is encouraged to try to correct the interference by one or more of the following measures:

- Relocate the receiving antenna.
- Increase the separation between equipment and receiver.
- Connect the equipment into an outlet on a circuit different from that to which the receiver is connected.
- Consult the dealer or an experienced radio/TV technician for help.

### Warning

- Changes or modifications made to this equipment not expressly approved by Philips may void the FCC authorization to operate this equipment.

### Note

- FCC/IC Radiation Exposure Statement: This equipment complies with FCC/IC radiation exposure limits set forth for an uncontrolled environment. End users must follow the specific operating instructions for satisfying RF exposure compliance.
- This transmitter must not be co-located or operating in conjunction with any other antenna or transmitter.

Philips Consumer Lifestyle  
A division of Philips Electronics North America Corporation  
P.O.Box 10313  
Stamford, CT 06904  
Phone: 1-888-PHILIPS (744-5477)

## Notice for Canada

Operation is subject to the following two conditions:

- ① This device may not cause interference<sup>3</sup> and
- ② This device must accept any interference, including interference that may cause undesired operation of the device. The term "IC:" before the certification / registration number only signifies that registration was performed based on a Declaration of Conformity indicating that Industry Canada technical specifications were met. It does not imply that Industry Canada approved the equipment.

## Trademarks

Trademarks are the property of Koninklijke Philips Electronics N.V. or their respective owners. The Bluetooth word mark and logos are owned by the Bluetooth SIG, Inc. and any use of such marks by Koninklijke Philips Electronics N.V. is under license.

## 2 Your bluetooth stereo headset

Congratulations on your purchase, and welcome to Philips! To fully benefit from the support that Philips offers, register your product at [www.philips.com/welcome](http://www.philips.com/welcome).

### Introduction

With the Philips Bluetooth stereo headset SHB6000, you can enjoy convenient wireless hands-free call. Ergonomically designed soft ear bud provides all-day wearing comfort. You can simply recharge your headset on your computer or with a USB charger. Spend a few minutes to learn more about your headset to enjoy your Philips Bluetooth stereo headset to its fullest.

### What's in the box

Check and identify the contents of your package:

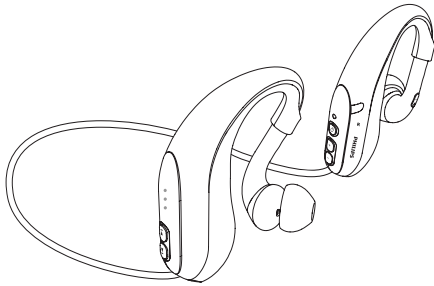

- Bluetooth headset

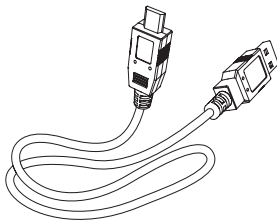

- USB charging cable

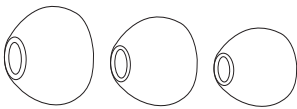

- Exchangeable rubber ear caps



- Quick start guide

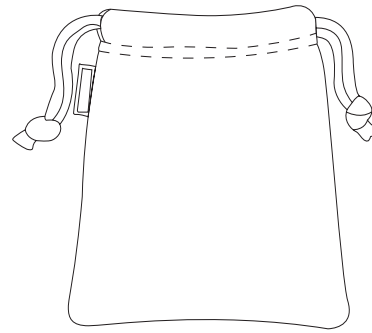

- Pouch

### Compatibility

Your headset is compatible with Bluetooth enabled mobile phones. It features Bluetooth version 2.1+EDR. It also works with devices featuring other Bluetooth versions that support the Headset profile (HSP), A2DP-Advanced Audio Distribution Profile, Hands-free profile (HFP) and Audio/Video remote control profile (AVRCP).

## Overview of your Bluetooth stereo headset



# 3 Get started

## Charge the headset

### Warning

- Before you use your headset for the first time, charge the battery for four hours for optimum battery capacity and lifetime.
- Use only the original USB charging cable to avoid any damage.
- Finish your call before charging the headset, as connecting the headset for charging will power off the unit.
- You can operate the headset normally during charge.

- 1 Remove the USB cap.

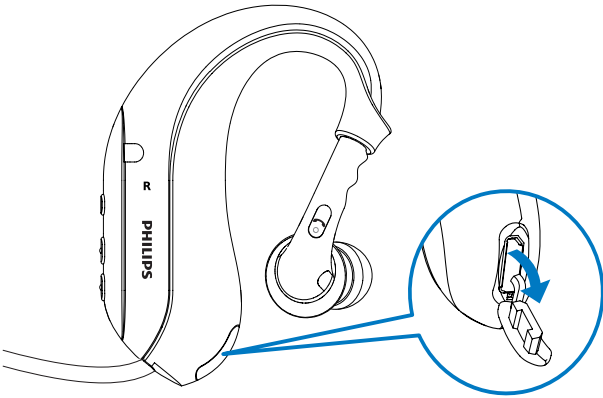

- 2 Plug the headset into a powered USB port with USB charging cable.  
↳ LED turns red during charge and turns off when the headset is fully charged.

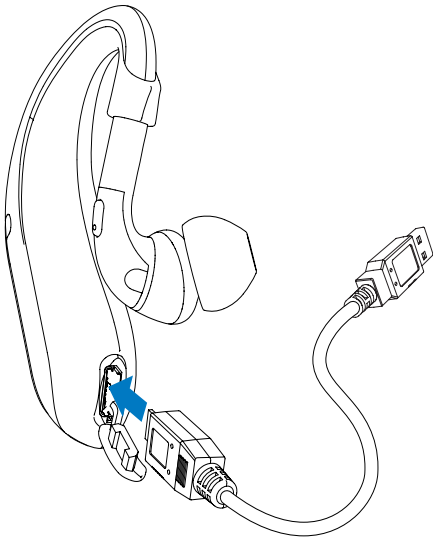

### Tip

- Typically, a full charge takes two hours.

## Pair the headset with your mobile phone

Before you use the headset with a mobile phone for the first time, pair it with the mobile phone. A successful pairing establishes a unique encrypted link between the headset and the mobile phone. The headset stores the last eight links in the memory. If you try to pair more than eight devices, the link for the earliest paired device is overwritten.

- 1 Ensure that the mobile phone is turned on and its Bluetooth feature is activated.
- 2 Ensure that the headset is charged and turned off.
- 3 Press **⓪** until the LED starts flashing **red** and **blue** alternately. Do not stop pressing the button after seeing the blue LED only.  
↳ The headset is in pairing mode, which lasts five minutes.
- 4 Pair the headset with the mobile phone. For details, refer to the user manual of the mobile phone.

A sample pairing is shown below.

- 1 Under Bluetooth menu on the mobile phone, search for the headset.
- 2 On mobile phones using Bluetooth 2.1+EDR or higher, you do not need to enter a pass code.
- 3 From the found devices, select **Philips SHB6000**.
  - Enter "0000" (4 zeros), if prompted to enter the pin code of the headset.

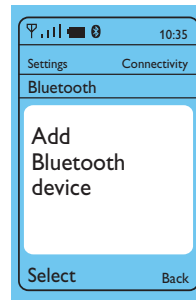

## 4 Use the headset

### Connect the headset to your mobile phone

- With the mobile phone turned on, press  $\phi$  until the LED lights up, to turn on the headset.
  - Once turned on, the headset reconnects automatically to the last device it was connected to.
  - If the last connected device is not available, the headset tries to reconnect to the second to last device that was connected to the headset. If it cannot find this device, it will look for all previously paired devices in the order of last usage, until it finds a device to connect to. The headset stores up to eight previously paired devices.



#### Tip

- If you turn on the mobile phone or its Bluetooth feature **after** turning on the headset, connect the headset from the Bluetooth menu of your mobile phone.

### Automatic power saving

If the headset cannot find any Bluetooth device to connect to in range within five minutes, it automatically powers down to save battery life.

### Get the best fit

- Choose the earbuds that best fit your ear canal.
- Gently blend the ear hook to fit into your ears.
- Adjust the rubber part of the ear hook to the height that you feel fit.
- Twist the earbuds to the right position for best fit and noise isolation.

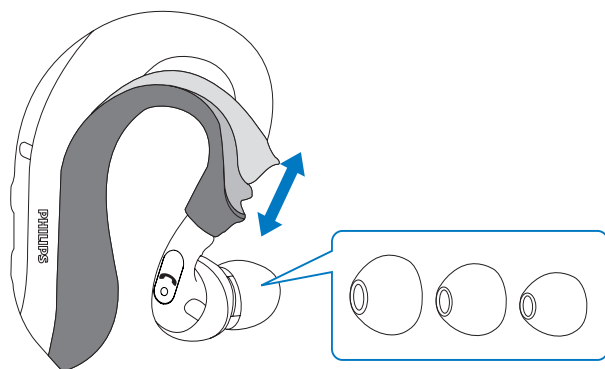

### Operate the headset

Enter pairing mode	Ensure the headset is off. Press $\phi$ until LED starts blinking red/blue alternately.
Check battery	When first use: Hold $\phi$ for 2 seconds. During operation: Hold <b>VOL +</b> and <b>VOL -</b> simultaneously, >50%: 1 blue flash >25%: 2 red flash <25%: 3 red flash
Turn headset on/off	Hold $\phi$ until LED turns on/off.
Play/Pause music	Tap $\curvearrowright$
Stop music	Hold $\curvearrowright$
Next / Previous track	Tap $\blacktriangle$ / $\blacktriangledown$
Adjust volume	Press <b>VOL +</b> / <b>VOL -</b>
Pick up / End a call	Tap $\curvearrowright$
Reject a call	Hold $\curvearrowright$
Redial the last number	Press $\curvearrowright$ twice quickly.
Activate voice dialing*	Hold $\curvearrowright$ until beep occurs.
Mute/Unmute the Mic	Double tap $\curvearrowright$ during a call.
Transfer a call to a mobile phone	Hold $\blacktriangle$ during a call.

\* Available if supported by your mobile phone.

### Manage 3-way calls

If your mobile phone and network operator support 3-way-calls, you can manage 3-way-calls via the headset.

To hold the active call and accept a waiting call	Press $\curvearrowright$ while the 2nd call is coming in.
To drop the active call and accept a waiting call	Hold $\curvearrowright$ while the 2nd call is coming in.
To swap a call	Press $\curvearrowright$ during a call.

### LED and sound indication

The red/blue LED flashes alternately.	The headset is ready for pairing.
The blue LED flashes once every 6 seconds.	The headset is connected to the device.
The blue LED flashes twice every 3 seconds.	The headset is not connected.
The blue LED flashes once every half a second.	There is an incoming/outgoing call.
The blue LED flashes once every second.	The headset is active on a call.
The red LED flashes three times and beeps twice every minute.	The battery is low in power.
Solid red LED.	The headset is charging.
The LED is off.	The headset is off./Charging is finished.
The headset beeps every 5 seconds.	The Mic is muted.

### Clean the headset

A few ways to clean the headset:

- Wipe with clean cloth.
- Wash it under running tap water.



#### Caution

- Do not dive with this product or immerse it into water.



## 5 Technical data

- Up to 4.5 hours of playtime or 5 hours of talk time
- Up to 120 hours of standby time
- Typical time for a full charge: 2 hours
- Rechargeable Lithium-Polymer battery (105 mAh)
- Bluetooth 2.1+EDR, Bluetooth stereo support (A2DP-Advanced Audio Distribution Profile, AVRCP-Audio/Video Remote Control Profile), Bluetooth mono support (HSP-Headset Profile, HFP-Hands-Free Profile)
- Acoustic echo cancelation
- Dual mic noise suppression
- Adjustable ear hook
- Noise isolating in-ear design
- Operating range up to 10 meters (33 feet)
- 3 sizes of ear caps included
- Quick-dry pouch included
- Sweat proof and fully washable

**Specifications are subject to change without notice.**

## 6 Frequently asked questions

### Bluetooth headset does not switch on.

- Battery is low.
  - ↳ Charge the headset.

### No connection to a mobile phone.

- Bluetooth disabled.
  - ↳ Enable the Bluetooth feature on your mobile phone and turn on the mobile phone before you turn on the headset.

### Pairing does not work.

- The headset is not in pairing mode.
  - ↳ Follow the steps described in this user manual.
  - ↳ Ensure that you see the LED light flashes red and blue alternately before you release the  $\phi$  button. Do not stop pressing the button after seeing the blue LED only.

### The mobile phone cannot find the headset.

- The headset may be connected to another previously paired device.
  - ↳ Turn the currently connected device off or move it out of range.
- Pairings may have been reset or headset has been previously paired with other device.
  - ↳ Pair the headset with the mobile phone again as described in the user manual.

### Voice dialing or redialing does not work.

- Your mobile phone may not support this feature.

### The other side cannot hear me, and I hear a beep noise every couple of seconds.

- The microphone is muted.
  - ↳ Quickly press  $\mathcal{C}$  twice to enable the microphone.

### Audio quality is poor and crackling noises can be heard.

- Bluetooth audio source is out of range.
  - ↳ Reduce the distance between the headset and the Bluetooth audio source, or remove obstacles between them.
- The earbud is not positioned correctly.
  - ↳ Ensure that you position the earbud as described in this user manual and adjust the ear hook to the best fit of your ears.

### I hear but cannot control the music on my device (e.g. skip forward/backward).

- Bluetooth audio source does not support AVRCP.
  - ↳ Check the user manual of your audio source.

Please visit [www.philips.com/welcome](http://www.philips.com/welcome) for additional support.

Philips Consumer Lifestyle

HK-1036-SHB6000

(Report No. / Numéro du Rapport)

2010

(Year in which the CE mark is affixed / Année au cours de laquelle le marquage CE a été apposé)

## EC DECLARATION OF CONFORMITY

(DECLARATION DE CONFORMITE CE)

We / Nous, PHILIPS CONSUMER LIFESTYLE B.V.

(Name / Nom de l'entreprise)

TUSSENDIEPEN 4, 9206 AD DRACHTEN, THE NETHERLANDS

(address / adresse)

Declare under our responsibility that the electrical product(s):

(Déclarons sous notre propre responsabilité que le(s) produit(s) électrique(s):)

PHILIPS

(brand name, nom de la marque)

SHB6000; SHB6000/00/10/28

(Type version or model, référence ou modèle)

Bluetooth Stereo Headset

(product description, description du produit)

To which this declaration relates is in conformity with the following harmonized standards:

(Auquel cette déclaration se rapporte, est conforme aux normes harmonisées suivantes)

(title, number and date of issue of the standard / titre, numéro et date de parution de la norme)

EN 300 328 V1.7.1:2006

EN 301 489-1 V1.8.1:2008; EN 301 489-17 V1.3.2:2008

EN50371:2002

EN 60950-1:2006/A11:2009

Following the provisions of :

(Conformément aux exigences essentielles et autres dispositions pertinentes de:)

1999/5/EC (R&TTE Directive) (Directive R&TTE 1999/5/CE)

And are produced under a quality scheme at least in conformity with ISO 9001 or CENELEC

Permanent Documents

(Et sont fabriqués conformément à une qualité au moins conforme à la norme ISO 9001 ou aux Documents Permanents CENELEC)

The Notified Body ..... performed ..... Notified Body Opinion  
(L'Organisme Notifié) (Name and number/ nom et numéro) (a effectué) (description of intervention / description de l'intervention)

And issued the certificate, .....  
(et a délivré le certificat) (certificate number / numéro du certificat)

Remarks:

(Remarques:)

Drachten, The Netherlands, 08.09.2010

(place, date / lieu, date)

A.Speelman, CL Compliance Manager

(signature, name and function / signature, nom et fonction)

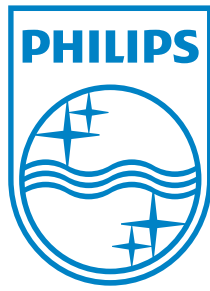

## Free Manuals Download Website

<http://myh66.com>

<http://usermanuals.us>

<http://www.somanuals.com>

<http://www.4manuals.cc>

<http://www.manual-lib.com>

<http://www.404manual.com>

<http://www.luxmanual.com>

<http://aubethermostatmanual.com>

Golf course search by state

<http://golfingnear.com>

Email search by domain

<http://emailbydomain.com>

Auto manuals search

<http://auto.somanuals.com>

TV manuals search

<http://tv.somanuals.com>