

ALIENWARE ®

CE → IV
CLOSE ENCOUNTER



is a trademark of SRS Labs, Inc. SRS WOW HD technology is incorporated under license from SRS Labs, Inc.

INTRODUCTION

Dear Valued Alienware Customer,

Alienware would like to take this opportunity to thank you for purchasing a cutting-edge CE-IV digital audio player and welcome you to the growing family of dedicated users who have been enjoying Alienware's award-winning products since 1996. Alienware products incorporate state-of-the-art components, innovative engineering and design, and unprecedented customer service. All of this combines to make Alienware the leading manufacturer of high-performance desktop, notebook, media center, and professional computer systems.

Your new Alienware CE-IV digital audio player allows you to listen to your favorite songs at the beach, at work, at the gym, on vacation, and everywhere else you go while delivering maximum ease-of-use and style.

The technicians responsible for creating your CE-IV digital audio player dedicated themselves to ensuring it is properly optimized and performs to its fullest potential. Your digital audio player has been extensively tested in order to ensure the highest levels of reliability and performance.

Please do not hesitate to e-mail or call Alienware with any questions or concerns you may have. Alienware would like to hear from you. The entire staff sincerely hopes that you enjoy your new CE-IV digital audio player for years to come.

Sincerely,

The Alienware Staff

CONTENTS INCLUDED

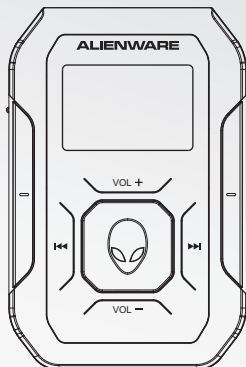

PLAYER

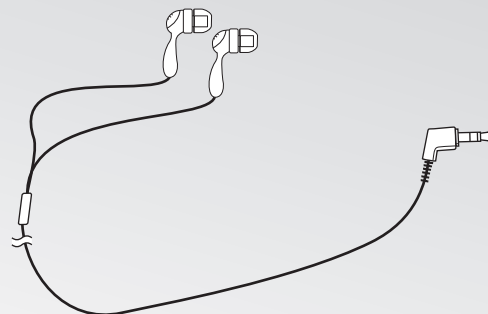

EARBUDS



INSTRUCTION BOOK



USB CABLE

INDEX

LOCATION OF CONTROLS	6
POWER SUPPLY	
INSERTING A BATTERY	7
AC POWER	7
CONNECTION	
POWER ON	8
POWER OFF	8
CONNECTING THE PLAYER TO YOUR COMPUTER	9
SAFELY DISCONNECTING THE PLAYER FROM YOUR COMPUTER	9
LISTENING TO MUSIC	
CONNECTING THE EARBUDS	10
MAIN MENU: MUSIC	10
SELECTING THE PLAY MODE	11
MANAGING YOUR FILES	11
EQ	12
LISTENING TO THE RADIO	
MAIN MENU: FM TUNER	13
RADIO SETTINGS	13
RECORD/PLAYBACK	
MAIN MENU: VOICE	14
RECORD	14
VOICE PLAY	14
REC OPTION	14
SETUP	
MAIN MENU: SETUP	15
SOUND SETTINGS	15
DISPLAY SETTINGS	15
DELETING FILES ON THE PLAYER	
MAIN MENU: DELETE	16
ABOUT	16
EXTERNAL MEMORY	
INSERTING EXTERNAL MEMORY	17
USING EXTERNAL MEMORY	17
TROUBLESHOOTING GUIDE	18
WARNINGS AND PRECAUTIONS	19
WARRANTY	20

LOCATION OF CONTROLS

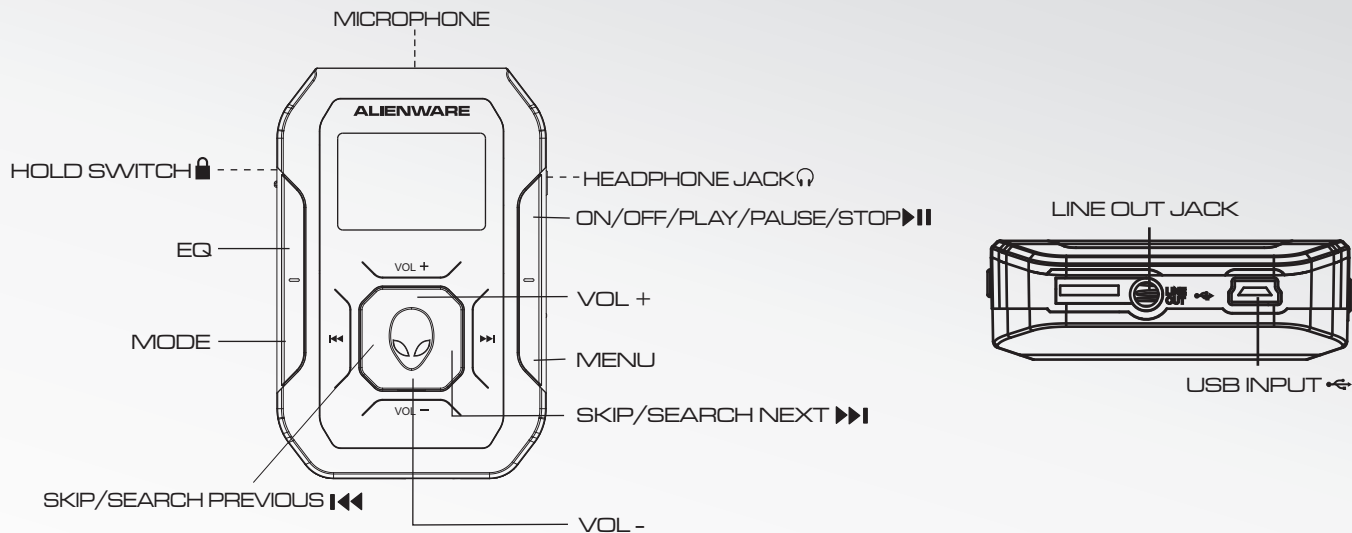

POWER SUPPLY

INSERTING A BATTERY

NOTE: The battery must be a rechargeable battery in order to recharge it.

When charging the battery for the first time, be sure to charge for at least 12 hours. Subsequent charges need only last approximately 5-6 hours for full charge or 3-4 hours for 95% charge.

When the battery is low the battery indicator will reflect low  power.

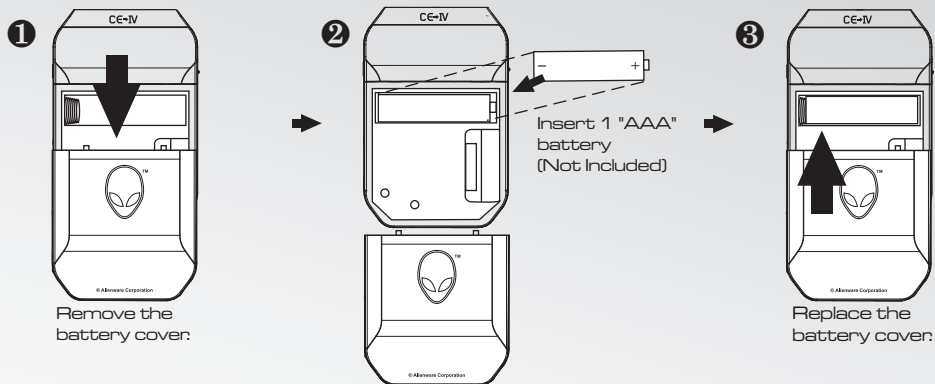

AC POWER

NOTE:

Before connecting to an AC power outlet, make sure the player is in the POWER OFF mode.

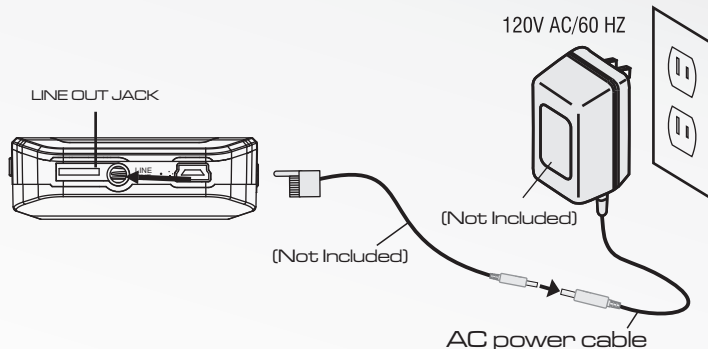

CONNECTION

POWER ON:

ON/OFF/PLAY/PAUSE/STOP



NOTE: When the player is turned on it will be in the MUSIC mode.

Press "▶||" to turn on the player:

POWER OFF:

ON/OFF/PLAY/PAUSE/STOP



Press "▶||" and hold to turn off the player:

CONNECTING THE PLAYER TO YOUR COMPUTER

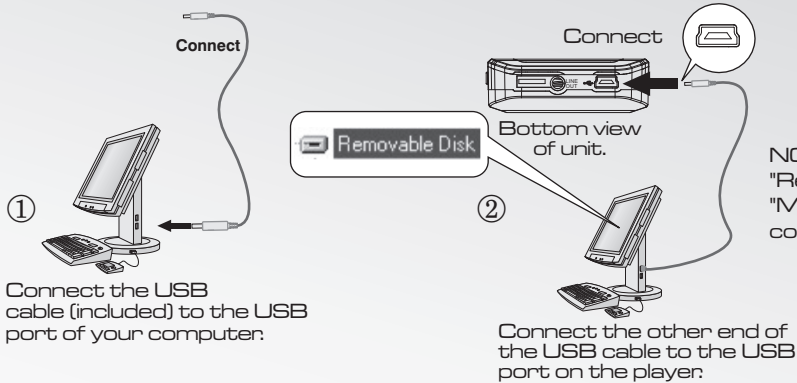

NOTE: You will see a new "Removable Disk" under "My Computer" when connected successfully.

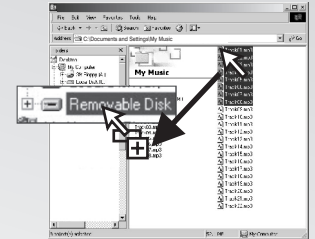

SAFELY DISCONNECTING THE PLAYER FROM YOUR COMPUTER

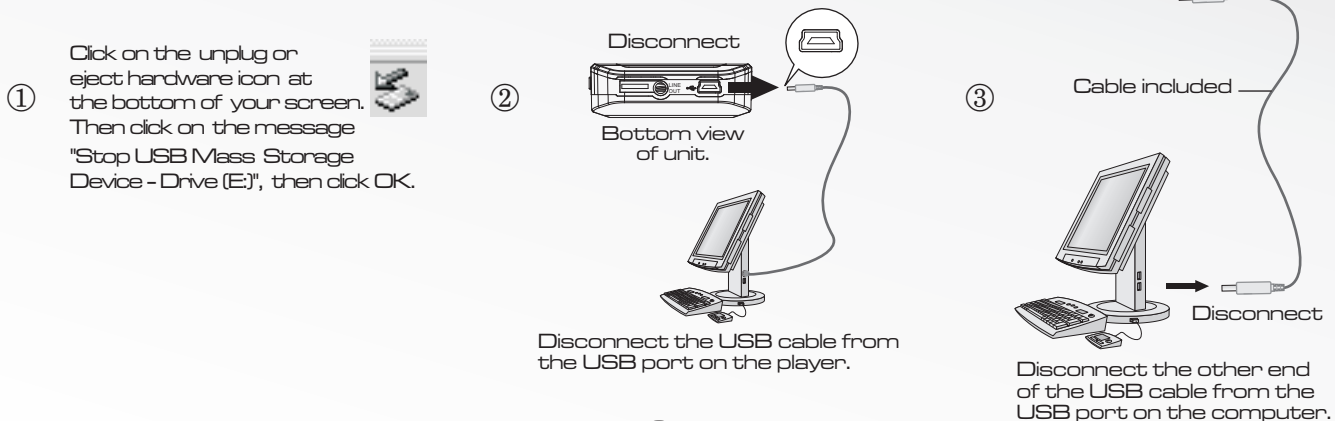

LISTENING TO MUSIC

CONNECTING THE EARBUDS

Slide "HOLD" switch to unlock. When "HOLD" switch is locked the keys will be locked and no function can be activated.

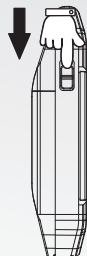

EARBUDS

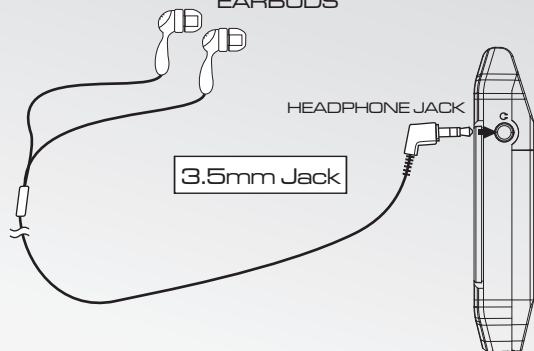

Set the Volume to a low level before putting on the headphones. Gradually adjust the Volume to a comfortable listening level.

MAIN MENU: MUSIC

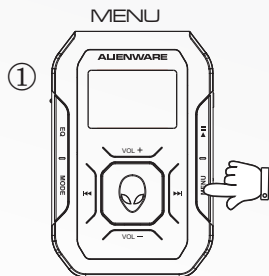

Press "MENU" to enter MAIN MENU.

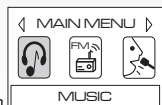

Press "MENU" to select MUSIC.

NOTE: In the STOP mode press the EQ button to switch from playing songs stored on the internal memory (Flash player) to playing songs stored on the external memory (memory card.)

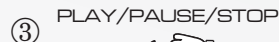
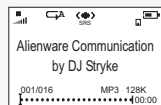

Press "▶▶" to start MUSIC. Press again to pause. Press and HOLD slightly to stop.



Press "⏮ or ⏭" to select a song.

LISTENING TO MUSIC

SELECTING THE PLAY MODE:

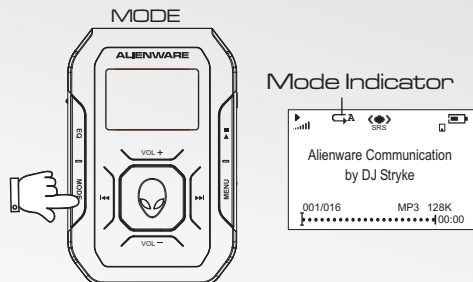

While the song is playing you can select the play mode by pressing the MODE button to choose between Normal, Repeat One, Repeat All, and Shuffle.

- REPEAT ONE = Will repeat the selected song continually.
- REPEATALL = Will repeat all songs continually.
- SHUF - SHUFFLE = Will choose at random which song to play.
- INTRO = Will play a few seconds of each song in order of entry.

MANAGING YOUR FILES:

LOCATING DESIRED TRACKS ON YOUR COMPUTER:

Use your computer's browser to locate the desired files to download to the player:

NOTE: Do not alter the contents of the "system" folder: This folder will normally be hidden from view. You can also use Windows Media® player to transfer songs. Refer to the help menu in Windows Media® player for more information.

DELETING TRACKS

1. Highlight the desired tracks in "Removable Disk".
2. Press the "Delete" key on your computer's keyboard.

NOTE: You cannot download songs from an audio CD directly to your player: Audio CD tracks will need to first be converted to MP3/WMA™ using third-party software.

STORAGE

You can also download photos, data, and other files to the player which allows the unit to function as a portable storage/transfer device.

EQ

In Play mode:



EQ has two functions:

1. **In Play mode:** Press the EQ button to choose between SRS, Normal, Rock, Jazz, Classic, Pop, and Bass.
2. **In Stop mode:** Press the EQ button to switch between internal memory and external memory.

In Stop mode:

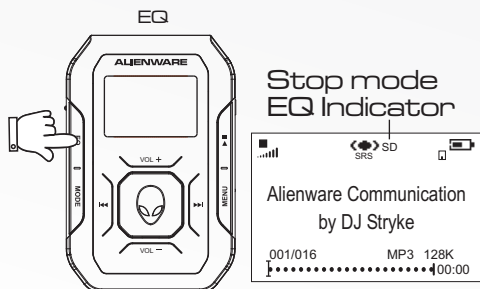

LISTENING TO THE RADIO

MAIN MENU: FM TUNER

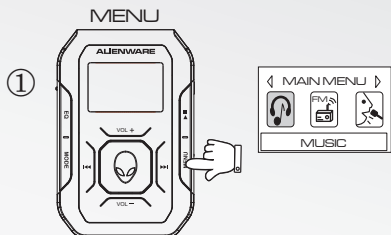

Press "MENU" to enter MAIN MENU.

② Press "◀ or ▶" to highlight FM TUNER.

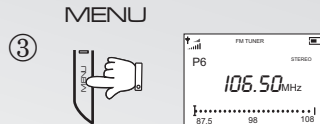

Press "MENU" to enter FM TUNER .

④ Press "◀ or ▶" to select your desired station.

NOTE: When FM TUNER is first selected it is in AUTO PROGRAM function. The player will automatically scan through and preset the available stations.

RADIO SETTINGS

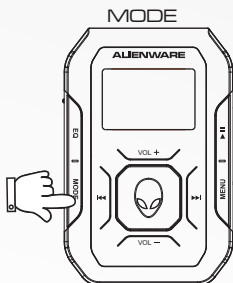

While the song is playing press the MODE button repeatedly to select between AUTO PROGRAM, PROGRAM, RECORD, and MANUAL.

Program Indicator

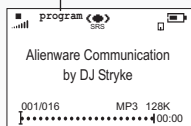

AUTO PROGRAM FUNCTION:

Once selected, press PLAY and the player will automatically scan through and preset the available stations.

PROGRAM FUNCTION:

First, press MODE and select MANUAL once selected then choose the desired station to program. Press PLAY to program the station into preset. You can program up to 30 preset stations.

RECORD FUNCTION:

Once you have selected what you want to record press the mode button until RECORD is seen in the display. Press PLAY to begin recording. Press PLAY again to stop recording.

MANUAL FUNCTION:

Will allow you to select stations manually.

RECORD/PLAYBACK

MAIN MENU: VOICE

RECORD

①  Press "MENU" to enter MAIN MENU.

②  Press "▶▶" to highlight VOICE.

③  Press "MENU" to select VOICE.

④  Press "MENU" to select VOICE.

⑤  Press "VOLUME -" to select RECORD.

⑥  Press "MENU" to start recording.

⑦  Press "STOP" to stop recording and return to VOICE menu.

VOICE PLAY

①  Press "MENU" to enter MAIN MENU.

②  Press "▶▶" to highlight VOICE.

③  Press "MENU" to select VOICE.

④  Press "MENU" again to select VOICE PLAY.

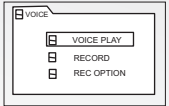
⑤  Press "▶▶" to play recorded messages. Press "STOP" to stop play, then press "MENU" to return to VOICE MENU.

⑥  Select EXIT and press "MENU" to exit VOICE and return to MAIN MENU.

Note: In STOP mode, press EQ button to switch play between INT or SD.

REC OPTION - Select location to save your recordings.

①  Press "MENU" to enter MAIN MENU.

②  Press "▶▶" to highlight VOICE.

③  Press "MENU" to select VOICE.

④  Press "VOLUME -" to highlight REC OPTION.

⑤  Press "MENU" to select REC OPTION.

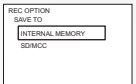
⑥  Press "VOLUME" to select between saving recording on INTERNAL MEMORY or SD/MMC.

⑦  Press "MENU" to confirm selection.

NOTE: When saving recordings the player will automatically select internal memory.

SETUP

MAIN MENU: SETUP

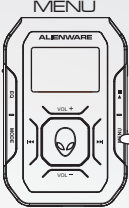
①  Press "MENU" to enter MAIN MENU.

②  Press "▶▶" to highlight SETUP.

③  Press "MENU" to select SETUP.

④  Press "Vol + or Vol -" to highlight one from the list.

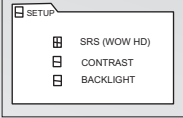
 Press "MENU" to accept selection and return to SETUP menu. Go to EXIT and press "MENU" to exit SETUP.



SOUND SETTINGS

SRS WOW HD™ The following four features make-up SRS WOW HD™ technology:

SRS 3D

Expands the sound field making the stereo image much wider. Creates a wide, spacious sound field.

FOCUS:

Elevates the stereo image providing clarity of vocals and vertically elevates sound stage so the reproduced sound is very natural.

Brightness: Choose the level of 3D stereo performance.

TruBass: Creates a deep rich bass tone through small speaker systems or headphones.

DEFINITION: Gives greater definition to the sound.

DISPLAY SETTINGS

CONTRAST: Choose the level of contrast you desire.

BACKLIGHT: Choose the level of brightness you desire.

POWER SET: Choose the amount of time the player stays on when not in use.

LANGUAGE: Choose between English, Spanish, or French.

EXIT: Choose Exit to return to the MAIN MENU.

DELETING FILES ON THE PLAYER

MAIN MENU: DELETE

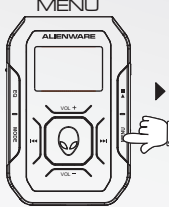
①  Press "MENU" to enter MAIN MENU.

②  Press "▶" to highlight DELETE.

③  Press "MENU" to select DELETE.

④  Press "Vol + or Vol -" to highlight what type of file will be deleted.

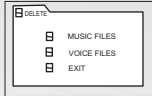
⑤  Press "MENU" to select the type of file to be deleted.

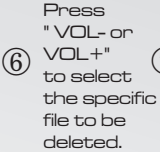
⑥  Press "VOL- or VOL+" to select the specific file to be deleted.

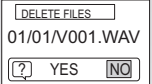
⑦  Press "◀ or ▶" to select YES or NO. Press "▶" to confirm.

ABOUT

MAIN MENU: ABOUT

①  Press "MENU" to enter MAIN MENU.

②  Press "▶" to highlight ABOUT.

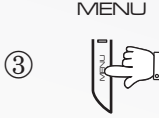
③  Press "MENU" to select ABOUT.

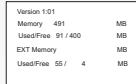
④  Version and memory information will be displayed.

⑤  Press "MENU" to return to MAIN MENU.

EXTERNAL MEMORY

INSERTING EXTERNAL MEMORY

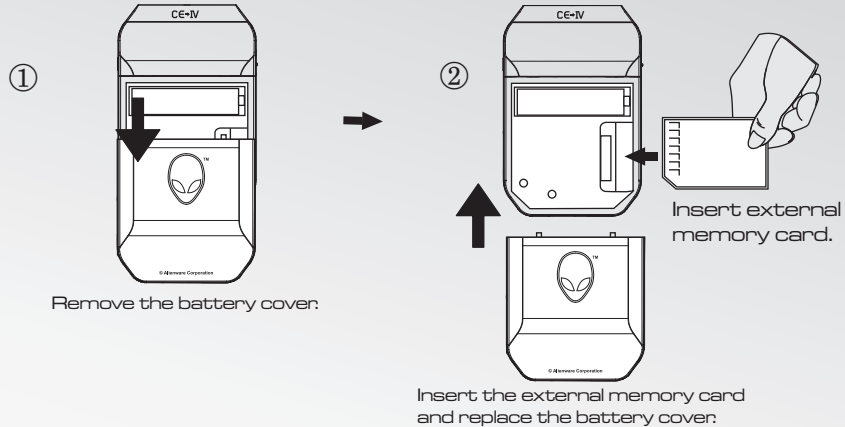

USING EXTERNAL MEMORY

1. Insert the memory card.
2. Connect the player to the computer: Follow detailed instructions on pages 10 and 11.
3. Open removable disk associated with the memory card.
4. Drag and drop selected songs into the removable disk.
5. Safely disconnect player from computer: Follow detailed instructions on page 10.

NOTE: To access external memory press EQ during the stop mode. This will switch your system from internal to external memory.

TROUBLESHOOTING GUIDE

TROUBLESHOOTING GUIDE	
PROBLEM	SOLUTION
Unit turned off or locked up.	Reinsert the battery in the correct polarity (+/-) and turn the unit on again.
	Replace the battery with a new one.
Sound is distorted or weak.	Lower the volume.
	Replace the battery with a new one.
Songs do not play after dragging/dropping or copying/pasting.	We recommend safely disconnecting any USB device in accordance with your computer's operating system instructions. In Windows® 98/Windows®ME, after copying files to the player, wait approximately 5 seconds before unplugging the unit. In Windows®2000/Windows® XP, click the USB icon in your computer's System Tray and "Stop [the]USB Mass Storage Device".
	Only MP3/WMA™ files can be played on this player.
Player does not work with Windows® 98.	Download the AW8825DAP device driver from the website and follow the accompanying instructions for installing (www.aliensware.com/audio).
External memory card does not work.	This player is compatible with up to 512MB SD or MMC cards.
	To transfer tracks to the external card: a) disconnect the player from your computer b) power up the player c) insert the memory card and d) connect the player to your computer and transfer tracks.

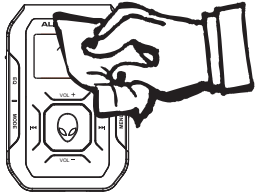

- Use a soft, clean cloth moistened with lukewarm water to clean the exterior of the unit.



- Never use solvents such as benzene or other strong chemical cleaners since these could damage the unit's finish.



- It is important that no liquid reaches the inside of the unit.



WARNINGS AND PRECAUTIONS

TO PREVENT FIRE OR SHOCK HAZARDS, DO NOT EXPOSE THIS UNIT TO RAIN OR MOISTURE.



This symbol, located on the back or bottom of the unit, is intended to alert the user to the presence of uninsulated "dangerous voltage" within the product's enclosure that may be of sufficient magnitude to constitute a risk of electric shock to persons.



This symbol, located on the back or bottom of the unit, is intended to alert the user to the presence of important operating and maintenance (servicing) instructions in the literature accompanying the appliance.

CAUTION: TO PREVENT ELECTRIC SHOCK, MATCH WIDE BLADE OF PLUG TO WIDE SLOT, FULLY INSERT

TO REDUCE THE RISK OF ELECTRIC SHOCK, DO NOT REMOVE COVER (OR BACK). THERE ARE NO USER-SERVICEABLE PARTS INSIDE. PLEASE REFER ANY SERVICING TO QUALIFIED SERVICE PERSONNEL.

WARNING: Changes or modifications to this unit not expressly approved by the party responsible for compliance could void the user's authority to operate the equipment

NOTE: This product complies with Council Directive 89/336/EEC. This class "B" digital apparatus complies with Canadian ICES-003. This device complies with Part 15 of the FCC Rules. Operation is subject to the following conditions: 1) The device may not cause harmful interference, and 2) This device must accept any interference received, including interference that cause undesired operation. This equipment has been tested and found to comply with the limits for a Class B digital device, pursuant to Part 15 of the FCC Rules. Receiver complies with Part 15 of FCC rules when manufactured. These limits are designed to provide reasonable protection against harmful interference in a residential installation. This equipment generates, uses, and can radiate radio frequency energy and, if not installed and used in accordance with the instructions, may cause harmful interference to radio communications. However, there is no guarantee that interference will not occur in a particular installation. If this equipment does cause harmful interference to radio or television reception, which can be determined by turning the equipment off and on, the user is encouraged to try to correct the interference by one or more of the following measures:

- Reorient or relocate the receiving antenna.
- Increase the separation between the equipment and receiver.
- Connect the equipment into an outlet on a circuit different from that to which the receiver is connected.
- Consult the dealer or an experienced radio/TV technician for help.

Special Note

When placing your unit on a lacquered or natural finish, protect your furniture with a cloth or other protective material.



We warrantee this product to the original purchaser to be free from defects in material and workmanship, under normal conditions, for a period of 90 days from date of original purchase.

We agree, at its option during the warranty period, to repair any defect in material or workmanship or to furnish an equal product in exchange without charge. Such repair or replacement is subject to verification of the defect or malfunction and proof of purchase as confirmed by a copy of an original dated sales receipt.

To obtain service, return the unit insured and freight PREPAID to:

ALIENWARE  CONSUMER SERVICE
2110 CARR STREET, ST. LOUIS, MO 63106
314 657-2364

- Pack the unit in a well-padded, sturdy carton.
- Enclose a copy of your sales receipt to verify the date of purchase.
- Include your name, address and phone number.

We will elect to repair or replace properly warranted product free of charge (including free return transportation).

NOTE: This warranty does not cover any product which has been subject to damage due to an act of God, misuse, neglect, accident, abuse, commercial use, or modification of, or to, any part of the product, including the antenna. Damage to external media such as DVD, CD, LP, tape and/or memory devices are not covered nor is the cost incurred in shipping the unit for warranty repair. Under no circumstances shall we be liable for any loss (direct, indirect, incidental, foreseen, unforeseen, special or consequential) or for any damage arising out of, or in connection with, the use of this product.

This warranty does not cover damage due to improper operation or maintenance, connection to improper voltage supply, or attempted repair by anyone other than us in, St. Louis, MO.

This warranty does not cover re-manufactured units, product sold AS IS or closeout product.

This warranty is valid only in the United States and grants specific legal rights. You may also have other rights which vary from state to state.

NOTE: For products that contain internal memory for storage of music, data, etc., the amount of memory your operating system reports may vary from the stated memory of this device.

2110 CARR STREET • ST. LOUIS, MO 63106 • TEL: 314 657-2364 • FAX: 314-588-1805

© 2005 Alienware Corporation. Alienware, the Alienware logo, and CE are trademarks or registered trademarks of Alienware Corporation. Manufactured under license by Alienware Corporation, Miami, FL 33186.

Free Manuals Download Website

<http://myh66.com>

<http://usermanuals.us>

<http://www.somanuals.com>

<http://www.4manuals.cc>

<http://www.manual-lib.com>

<http://www.404manual.com>

<http://www.luxmanual.com>

<http://aubethermostatmanual.com>

Golf course search by state

<http://golfingnear.com>

Email search by domain

<http://emailbydomain.com>

Auto manuals search

<http://auto.somanuals.com>

TV manuals search

<http://tv.somanuals.com>