

READ ALL INSTRUCTIONS BEFORE FIRST USE
 Thank you for purchasing the CAT EYE ABS Advanced Battery System, a unique 6 volt rechargeable head lamp series. ABS-10 is a combination system of a lamp, battery pack and charger. Before operating, thoroughly familiarize yourself with this manual so that you understand the light's safe and correct operation. Please keep this manual, along with the warranty card, for future reference.

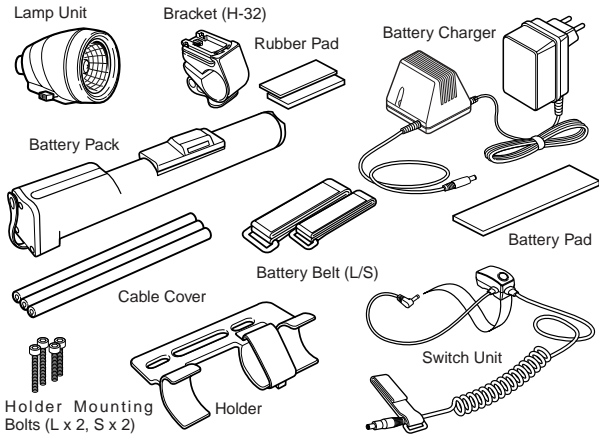

BEFORE FIRST USE:

The factory-loaded battery pack is not fully charged; the charge is useful only for testing! Before first use, charge the battery fully following the instructions on [RECHARGING INSTRUCTIONS].

CONTENTS

The ABS-10 are the combined system of the following parts. Make sure that your package includes all the parts.

SAFE OPERATIONS (IMPORTANT)

WARNING

- Never short-circuit the terminal of the battery pack and the plug of the battery charger. It may cause the battery to over heat, resulting in fire or damage of the components.
- Securely connect the plug so that the light will not turn off while riding, or the cord will not hinder riding.
- Never use the ABS if the cord of the battery charger or the switch unit is damaged, Consult with the shop where this lamp kit was purchased.
- The lamp body becomes extremely hot when turned on. Never touch the lamp body or the lens until thoroughly cooled. Injury may result.

Important Note

- Use only the designated battery charger for charging.
- Never mix different types of battery packs.
- Safely and properly dispose of the old battery according to your local regulations when it comes to the end of its useful life.
- This lamp kit is not intended for use by young children or infirm persons without supervision. Young children should be supervised to ensure that they do not play with this appliance.
- The battery's nature will affect the light output, High light output will remain just before the battery runs out, After that the output drops suddenly. Take precautions against such a situation and prepare a spare light or spare battery packs.
- Long periods of non-use will lower the voltage of the battery and will naturally self discharge. Always charge the battery before using.
- Overdischarge (leaving the light on after the power is completely gone) shortens the performance life of the battery.
- If the lamp body or parts become dirty with mud, etc., clean with a soft cloth which is moistened with mild soap. Never apply paint thinner, benzene or alcohol; damage will result.

HOW TO SETUP

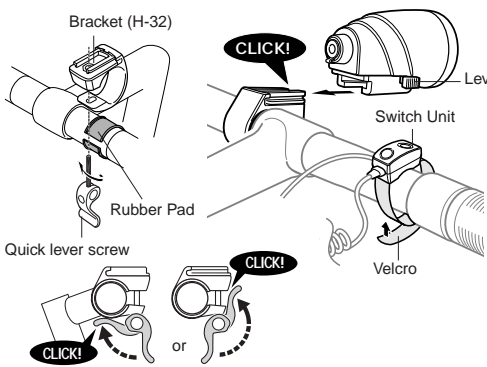

Attach the bracket (H-32) to the handlebar. Turn over the quick lever and it is fastened. Slide the lamp units onto the brackets. To remove the lamp body, slide it forward while pushing the lever. **Note:** Use the quick lever to adjust 10° horizontally.

Warning!!! When removing the lamp body, make sure that it has been cooled.

Attach the switch unit onto the handlebar where it will not hinder the braking and shifting operation.

Connecting Battery Pack and Cord

Choose your favorite location to attach the battery packs.

When attaching to bottle cage

Attach the holder onto the down tube using the holder mounting bolts (L or S).

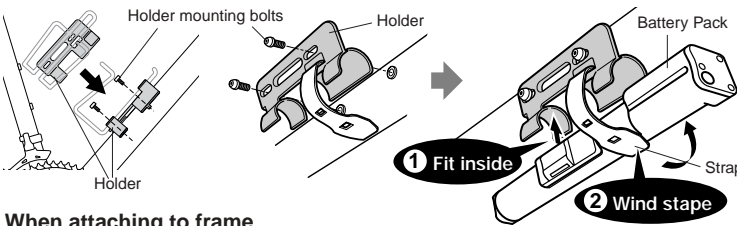

Attention: Fix the battery pack securely with the hold-down straps. For safety's sake, also use the battery belts (velcro straps) to secure the batteries.

When attaching to frame

Fix the battery pack firmly to the frame, using the battery belts. Cut the battery pad and fit it between the top tube and the battery, so that the battery will not move when riding.

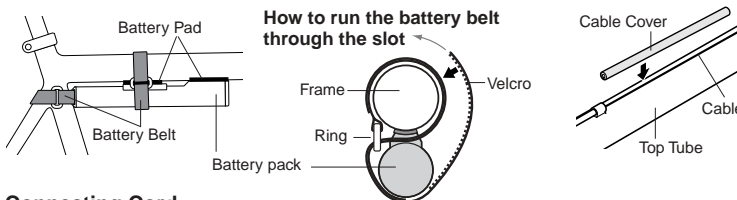

Attention: If the cable is not covered by cable housing, use the included cable cover to prevent direct contact between the cable and the belts. (Cut the cable cover to the suitable length.)

Connecting Cord

Connect the battery pack, joint cord and the switch unit as illustrated.

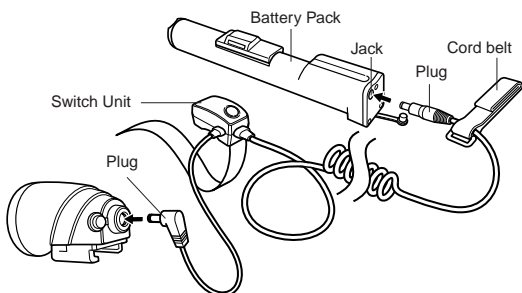

- Attention:**
- Secure the cord along the frame with the cord belt, so that it will not hinder riding.
 - Wind the cord round the frame so that it will not hinder riding.
 - Securely connect the jacks to the plug.

Note: You can connect one more battery pack (available as an optional part). This way the run time will be double. For this connection, the Double Holder (#533-8785) is recommended.

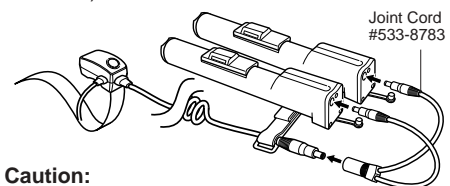
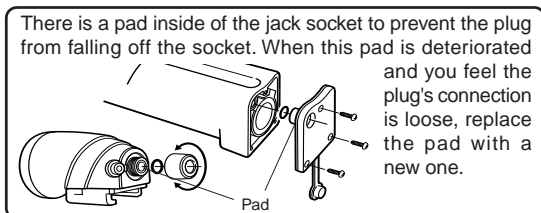

Caution: In this double connection, the two batteries must be evenly discharged. Do not mix batteries that are in different states of charge.

HOW TO SWITCH ON/OFF

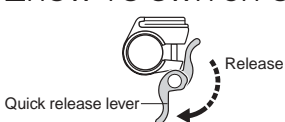

The switch unit controls the operation of the lamps.

Run Time: 1.5 hrs

Note: The run time shown here is the calculated figure.

- The beam angle must be downwards.
- To adjust the angle of the lamp unit, use the quick lever.

RECHARGING INSTRUCTIONS



- Recharge after thorough discharge. (in order to prevent memory after effect)
- Use exclusive charger.

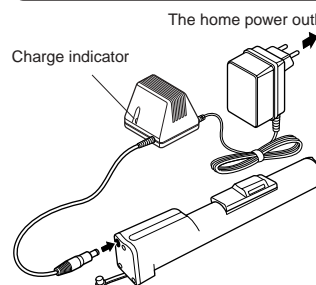

Standard Charging Time
8-10 hours

- Recharge only when battery power has completely diminished.
 - Recharged both batteries at the same time.
 - Use only the ABS recharger.
 - For indoor use only.
- Note:**
- Red indicator color ---- Empty/Not charged.
 - Green indicator color - Fully charged.
 - Battery life will vary due to adverse conditions.
 - Fully charged batteries that yields no power means battery life is dead.

HOW TO REPLACE THE BULB

Disassemble the lamp unit as illustrated.

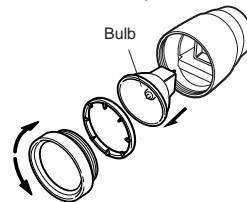

- Caution:**
- Do not rotate the bulb but pull it straight out.
 - Use only 10W bulb. Other bulbs will cause the lamp body to melt.
 - To replace bulb, first let it cool down.
 - Use only the CAT EYE 6V halogen bulb.

SAFETY SYSTEM (AUTO-RESET FUSE)

When an electrical surge or malfunction occurs in the circuit or the temperature of the battery rises, the fuse blows due to its safety system and the circuit will be closed. After leaving it for a while, the fuse will automatically recover.

Note: If the fuse continues to blow, or if the fuse does not recover, call the appropriate service center for assistance.

SPECIFICATIONS

Bulb:	6V Halogen wide bulb (10W)
Battery pack:	Hi Ni-MH battery 6V 3000mAh
Battery charger:	Hi Ni-MH charger CHR-3005
Standard charging time:	8-10 hours
Temperature range:	Charging: 0°C - 40°C Operating: -15°C - 45°C
Recharge/discharge number of times:	about 500 times (until the rated capacity drops to 50%)

* The specifications and design are subject to change without notice.

LIMITED WARRANTY

2-Year Warranty: Only for lamp unit, switch unit, battery pack and charger (excluding bulb and deteriorated battery)

If trouble or damage occurs during normal use, the product will be repaired or replaced free of charge. Type your name, address, date of purchase and the situation of trouble clearly on the warranty certificate, and send it back to the appropriate service center together with the product. Insurance, handling and transportation charges shall be borne by the customer. After being repaired or replaced, the product will be shipped back to the customer.

Address for service: CATEYE CO., LTD.

2-8-25 Kuwazu, Higashi Sumiyoshi-ku Osaka 546-0041 JAPAN
 Attention: CAT EYE International Customer Service Section
Service Center for the United States Customers
CATEYE Service & Research Center
 1705 14th Street #115, Boulder, CO 80302
 Phone: 303-443-4595 Fax: 303-473-0006 Toll Free: 800-5CATEYE (800-522-8393)
 e-mail: service@cateye.com web site: www.cateye.com

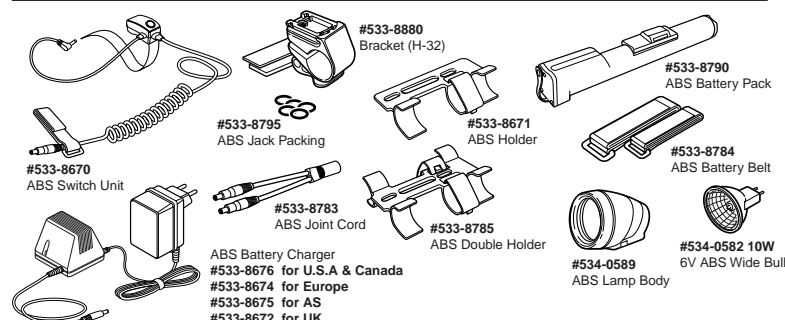

Free Manuals Download Website

<http://myh66.com>

<http://usermanuals.us>

<http://www.somanuals.com>

<http://www.4manuals.cc>

<http://www.manual-lib.com>

<http://www.404manual.com>

<http://www.luxmanual.com>

<http://aubethermostatmanual.com>

Golf course search by state

<http://golfingnear.com>

Email search by domain

<http://emailbydomain.com>

Auto manuals search

<http://auto.somanuals.com>

TV manuals search

<http://tv.somanuals.com>