

**COBY Electronics Corp.**

56-65 Rust Street  
Maspeth, NY 11378

[www.cobyusa.com](http://www.cobyusa.com)  
[www.ecoby.com](http://www.ecoby.com)

**COBY®**

**DP-767**

**7" Widescreen Color TFT LCD Digital Photo Frame  
with Video and Music Playback**

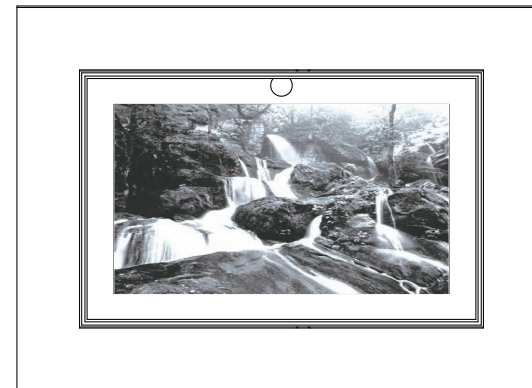

767ZR



## **INSTRUCTION MANUAL**

**Please read this manual carefully before operation**

## PRECAUTIONS

	<b>CAUTION</b> WARNING: SHOCK HAZARD. DO NOT OPEN. AVIS: RISQUE DE CHOC ELECTRIQUE. NE PAS OUVRIR	
<b>CAUTION:</b> TO REDUCE THE RISK OF FIRE AND ELECTRIC SHOCK, DO NOT REMOVE THE COVER (OR BACK) OF THE UNIT. REFER SERVICING ONLY TO QUALIFIED SERVICE PERSONNEL.		



The lightning flash with arrowhead symbol within an equilateral triangle is intended to alert the user to the presence of uninsulated "dangerous voltage" within the product's enclosure that may be of sufficient magnitude to constitute a risk of electric shock.



The exclamation point within an equilateral triangle is intended to alert the user to the presence of important operation and servicing instructions in the literature accompanying the appliance.

### For Customer Use:

Enter below the serial number that is located on the bottom of the unit. Retain this information for future reference.

Model No. \_\_\_\_\_ DP-767 \_\_\_\_\_

Serial No. \_\_\_\_\_



For recycling or disposal information about this product, please contact your local authorities or the Electronics Industries Alliance: [www.eiae.org](http://www.eiae.org).

## PRECAUTIONS

### WARNING:

To prevent fire or shock hazard, do not expose this device to rain or moisture. Dangerous high voltage is present inside the enclosure. Do not open the cabinet.

### CAUTION:

To prevent electric shock, match wide blade of plug to wide slot of outlet and fully insert.

### Protect your hearing:

Hearing experts advise against the constant use of personal stereos played at high volume. Constant exposure to high volumes can lead to hearing loss. If you should experience ringing in the ears or hearing loss, discontinue use and seek medical advice.

## IMPORTANT SAFETY INSTRUCTIONS

1. **Read Instructions:** All the safety and operating instructions should be read before the product is operated.
2. **Retain Instructions:** The safety and operating instructions should be retained for future reference.
3. **Heed Warnings:** All warnings on the product and in the operating instructions should be adhered to.
4. **Follow Instructions:** All operating and usage instructions should be followed.
5. **Cleaning:** Unplug this product from the wall outlet before cleaning. Do not use liquid cleaners or aerosol cleaners. Use a damp cloth for cleaning.
6. **Attachments:** Use only attachments recommended by the manufacturer. Use of other attachments may be hazardous.
7. **Water and Moisture:** Do not use this product near water (e.g., near a bath tub, washbowl, kitchen sink, laundry tub, in wet basements, or near a swimming pool and the like).
8. **Accessories:** Do not place this product on an unstable cart, stand, tripod, bracket, or table. Use only with carts, stands, tripods, brackets, or tables recommended by the manufacturer or sold with the product. Any mounting of the product should follow the manufacturer's instructions and should use a mounting accessory recommended by the manufacturer.
9. A product and cart combination should be moved with care. Quick stops, excessive force, and uneven surfaces may cause the product and cart combination to overturn.
10. **Ventilation:** Slots and openings in the cabinet are provided for ventilation to ensure reliable operation of the product and to protect it from overheating. These openings should never be blocked by placing the product on a bed, sofa, rug, or other similar surface. This product should not be placed in a built-in installation such as a bookcase or rack unless proper ventilation is provided or the manufacturer instructions have been adhered to.
11. **Power Sources:** This product should be operated only from the type of power source indicated on the rating label. If you are not sure of the type of power supply to your home, consult your product dealer or local power company. For products intended to operate from battery power or other sources, refer to the operating instructions.



## IMPORTANT SAFETY INSTRUCTIONS

12. **Grounding or Polarization:** This product may be equipped with a polarized alternating-current line plug that has one blade wider than the other. This plug will only fit into the power outlet in one direction. This is a safety feature. If you are unable to insert the plug fully into the outlet, try reversing the direction of the plug. If the plug should still fail to fit, contact an electrician to replace the obsolete outlet. Do not defeat the safety purpose of the polarized plug.
13. **Power-Cord Protection:** Power supply cords should be routed so that they are not likely to be walked on or pinched by items placed upon or against them, paying particular attention to cords at plugs, convenience receptacles, and at the point which they exit from the product.
14. **Protective Attachment Plug:** The product may be equipped with an attachment plug with overload protection. This is a safety feature. See the operating instructions for replacement or directions to reset the protective device. If replacement of the plug is required, be sure the service technician has used a replacement plug that has the same overload protection as the original plug as specified by the manufacturer.
15. **Outdoor Antenna Grounding:** If an outside antenna is connected to the product, be sure the antenna system is grounded so as to provide some protection against voltage surges and built-up static charges. Article 810 of the National Electrical Code, ANS/NFPA 70 provides information with regard to proper grounding of the mast and supporting structure, grounding of the lead-in wire to an antenna-discharge unit, size of grounding conductors, location of antenna-discharge unit, connection to grounding electrodes, and requirements for the grounding electrode (see figure).

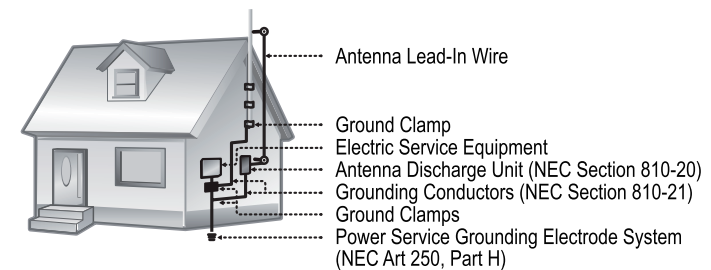

## IMPORTANT SAFETY INSTRUCTIONS

16. **Lightning:** For added protection for this product, unplug it from the wall outlet and disconnect the antenna or cable system during a lightning storm or when it is left unattended and unused for long periods of time. This will prevent damage to the product due to lightning or power-line surges.
17. **Power Lines:** An outside antenna system should not be located in the vicinity of overhead power lines or other electric light or power circuits, or where it can fall into such power lines or circuits. When installing an outside antenna system, extreme care should be taken to keep from touching such power lines or circuits, as contact with them might be fatal.
18. **Overloading:** Do not overload wall outlets, extension cords, or integral convenience receptacles as this can result in a risk of fire or electric shock.
19. **Object and Liquid Entry:** Never push objects of any kind into this product through openings as they may touch dangerous voltage points or short-out parts that could result in a fire or electric shock. Never spill liquid of any kind on the product.
20. **Servicing:** Do not attempt to service this product yourself as opening or removing covers may expose you to dangerous voltage or other hazards. Refer all servicing to qualified service personnel.
21. **Damage Requiring Service:** Unplug this product from the wall outlet and refer servicing to qualified service personnel under the following conditions: a) when the power-supply or plug is damaged; b) if liquid has been spilled or if objects have fallen into the product; c) if the product has been exposed to rain or water; d) if the product does not operate normally by following the operating instructions. Adjust only those controls that are covered by the operating instructions as improper adjustment of other controls may result in damage and will often require extensive work by a qualified technician to restore the product to its normal operation; e) if the product has been dropped or damaged in any way; f) when the product exhibits a distinct change in performance—this indicates a need for service.
22. **Replacement Parts:** When replacement parts are required, be sure that your service technician has used replacement parts specified by the manufacturer or have the same characteristics as the original part. Unauthorized substitutions may result in fire, electric shock, or other hazards.
23. **Safety Check:** Upon completion of any service or repairs to this product, ask the service technician to perform safety checks to ensure that the product is in proper operating condition.

## IMPORTANT SAFETY INSTRUCTIONS

24. **Wall or Ceiling Mounting:** The product should be mounted to a wall or ceiling only as recommended by the manufacturer.
25. **Heat:** The product should be situated away from heat sources such as radiators, heat registers, stoves, or other products (including amplifiers) that produce heat.

## TABLE OF CONTENTS

<b>PRECAUTIONS .....</b>	<b>2</b>
<b>IMPORTANT SAFETY INSTRUCTIONS.....</b>	<b>4</b>
<b>TABLE OF CONTENTS .....</b>	<b>8</b>
<b>PACKAGE CONTENTS .....</b>	<b>10</b>
<b>FEATURES .....</b>	<b>11</b>
<b>LOCATION OF CONTROLS.....</b>	<b>12</b>
Top View.....	12
Left View .....	12
Front View .....	12
Right View .....	12
Remote Control.....	13
<b>GETTING STARTED .....</b>	<b>14</b>
Using the Remote Control.....	14
Installing a Memory Card.....	15
Powering your Digital Picture Frame .....	15
Turning Your Photo Frame On/Off.....	16
Menu Interface Navigation.....	16
Main Menu Screen .....	17
Available Selected Card .....	18
<b>MUSIC &amp; VIDEO MODE .....</b>	<b>19</b>
Music& Video List .....	19
Advanced Settings.....	19
Filter .....	19
Flat Mode.....	20
Program.....	20
Audio&Video Controls .....	21
Audio Controls .....	21
Video Controls .....	21
To Adjust Screen Brightness,Contrast & Color.....	21

## TABLE OF CONTENTS

<b>PHOTO MODE .....</b>	<b>22</b>
Photo List .....	22
Photo View .....	22
Zoom .....	23
Rotate.....	23
Screen size (Screen Ratio).....	23
Slideshow.....	23
<b>SETUP MENU .....</b>	<b>24</b>
Lauguage Options .....	24
Photo Options .....	24
Reset Options .....	25
<b>CABLE CONNECTION .....</b>	<b>26</b>
Headphones.....	26
Composite Video.....	27
<b>INTERCHANGEABLE FACEPLATE .....</b>	<b>28</b>
<b>FIRMWARE UPGRADES.....</b>	<b>29</b>
<b>TROUBLESHOOTING .....</b>	<b>30</b>
<b>SPECIFICATIONS .....</b>	<b>32</b>

## PACKAGE CONTENTS

Please make sure that the items shown below are included in the package. Should an item be missing, please contact the local retailer from which you purchased this product.

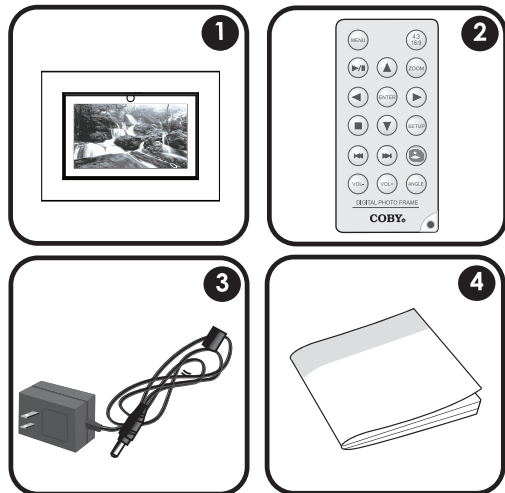

1. COBY DP-767
2. Remote Control

3. AC Adapter
4. Manual

## FEATURES

- 7" Widescreen TFT LCD Color Screen
- Displays JPEG Photo Files
- Plays MP3 and WMA Music Files
- Plays most Video Files for Digital Cameras(AVI, MPG, XVID, DIVX)
- AV Output for use with Home Theater Systems
- SD, MMC, xD ,MS and CF Card Slots
- USB port for use with USB Flash Drives
- Integrated Stereo Speakers
- Interchangeable Faceplate
- Detachable Stand
- Full Function Remote Control
- Wall Mountable

## LOCATION OF CONTROLS

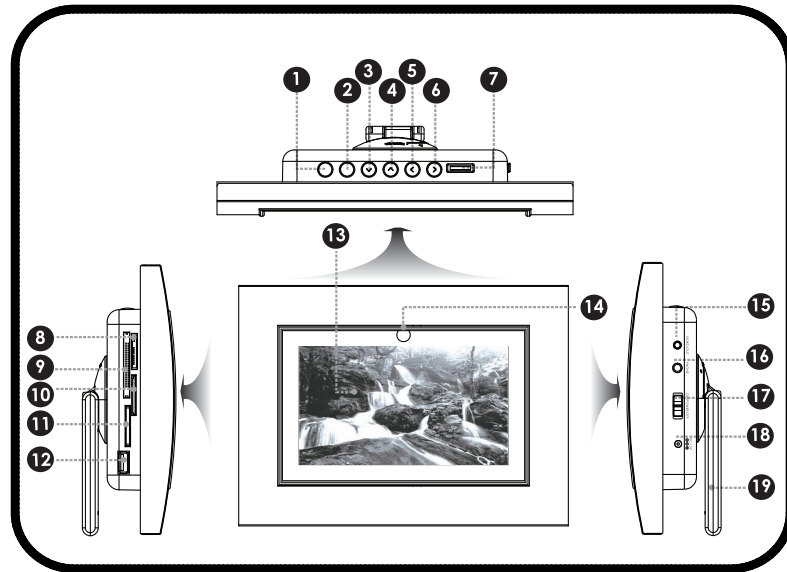

### Top View

1. **Menu/Setup**  
Press once for Menu;  
Press and hold for Setup
2. **Enter/Slideshow**  
Press for Enter
3. Down
4. Up
5. **Left/ Fast Reverse**  
Press for Left during selecting  
Press for Fast Reverse during Audio/Video playback

6. **Right/Fast Forward**  
Press for Right during selecting  
Press for Fast forward during Audio/Video playback
7. Volume Level dial

### Left View

8. Memory Stick(MS)
9. Compact Flash (CF)
10. xD-Picture (xD)
11. Secure Digital (SD) / Multi Media Card (MMC)

12. USB Port  
(for use with USB flash drives)

### Front View

13. 7" TFT LCD (16:9)
14. Remote Sensor

### Right View

15. Video Out
16. Headphone / Audio Out
17. Power Switch (On / Off)
18. Power In Jack
19. Detachable Kickstand

## LOCATION OF CONTROLS

### Remote Control

1. Menu
2. Screen Size (4:3 / 16:9)
3. Play / Pause
4. Zoom
5. Up (Navigation)
6. Left (Navigation)
7. Down (Navigation)
8. Right (Navigation)
9. Enter
10. Stop
11. Previous / Reverse
12. Next / Forward
13. Volume Down
14. Volume Up
15. Angle
16. Setup
17. Slideshow

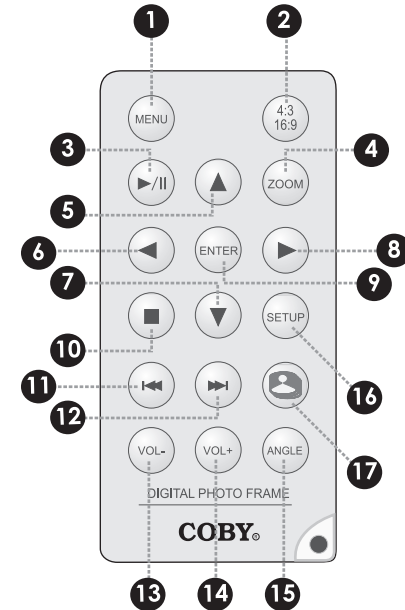

## GETTING STARTED

### Using the Remote Control

To load a battery in the remote:

1. Pull in the direction of the arrow
2. Slide the compartment out
3. Place the battery in the compartment with the positive side ( + ) facing up
4. Push the compartment in to close

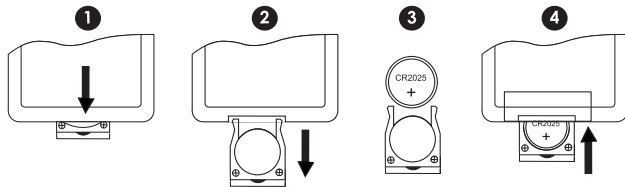

To use the remote:

- Point the remote at the remote sensor of the photo frame at a distance of no more than 15' and at an angle no greater than 60 degrees.
- Batteries will last for about one year under typical usage. Replace the batteries if the remote is no longer working.
- Do not spill water on the remote control.
- Do not use the remote control for other equipment at the same time.
- Remove the batteries if the remote control will not be in use for an extended period of time.



*The battery used in this device may present a fire or chemical hazard if mistreated. Do not recharge, disassemble, incinerate, or heat the batteries.*

*Used batteries should be disposed of safely and not incinerated. Attention should be shown to the environment aspects of battery disposal.*

*Keep batteries out of the reach of children.*

## GETTING STARTED

### Installing a Memory Card

Your picture frame supports the following types of memory cards:

- Compact Flash cards (CF)
- Secure Digital cards (SD)
- MultiMedia Card (MMC)
- xD-Picture card (xD)
- Memory Stick (MS)

Simply insert the memory card of your choice into its corresponding card slot located on the left panel of the photo frame. Take care to orient the card in the proper direction.

Getting photos and files onto your picture frame for viewing couldn't be easier!

### Powering your Digital Picture Frame

Your Picture Frame should be connected to an AC 100-240V wall outlet.

- Using the supplied power adapter, plug one end of the adapter into your photo frame's Power In Jack and plug the other end into an AC 100-240V wall outlet.

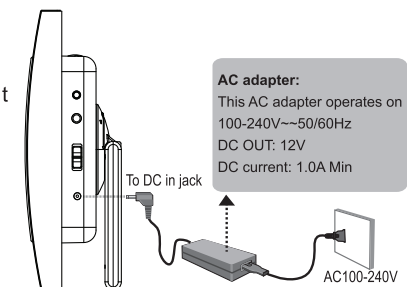

*Do not connect the power plug to a power outlet other than that which is indicated here or on the label as this may result in the risk of fire or electric shock.*

*Do not handle the power plug with wet hands. Doing so may cause electric shock.*

*Use only AC adapters of the type specified here. Failure to do so may cause a fire or damage the player.*



## GETTING STARTED

### Turning Your Photo Frame On/Off

- To turn your photo frame on, set the Power Switch to the "On" position.
- To turn your photo frame off, set the Power Switch to the "Off" position.

### Menu Interface Navigation

To select the different menu options and files of your digital photo frame:

- Use the Navigation keys to make a selection.
  - To move the selection up, press ▲  
To scroll up quickly, press and hold ▲
  - To move the selection down, press ▼  
To scroll down quickly, press and hold ▼
  - To move the selection left, press ◀  
To scroll left quickly, press and hold ◀
  - To move the selection right, press ▶  
To scroll right quickly, press and hold ▶
- **Press ENTER to confirm the highlighted selection.**
- To return to Available Selected Card Dialogue Box, press MENU. Press again to exit.

## GETTING STARTED

### Main Menu Screen

Insert a card to the corresponding slot, turn on the player, your photo frame will display the "Main Menu" screen shown below.

- Use the navigation keys to select a desired photo/audio/video file and press ENTER to play.

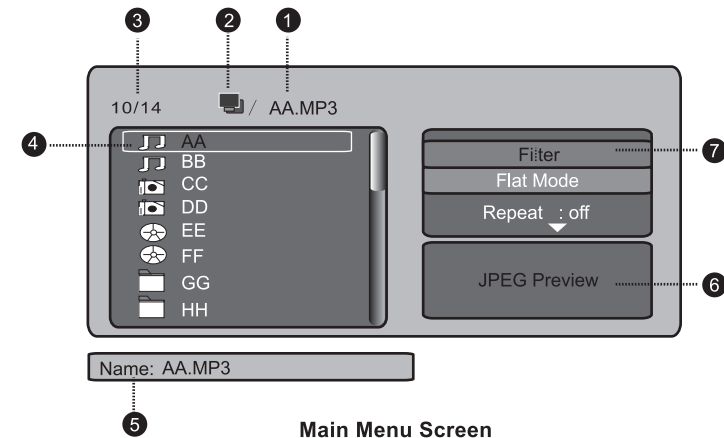

1. Filename of Current playback file
2. Current Disk Icon
3. Current File Number/Total Number of Files
4. Current Playback File
5. Name/Artist/Album/Year/Track/Comment of current playback file
6. JPEG Preview (Photos)/Music Playing (Audio Files)
7. Advanced Settings



The digital photo frame is equipped with a **demo slideshow** that will automatically start after 10 seconds if there is no card inserted. The demo slideshow will stop when a card is inserted or any button is pressed.

## GETTING STARTED

### Available Selected Card

Upon the cards inserted, press the MENU button, your photo frame will display the "Available Selected Card" dialogue box shown below.

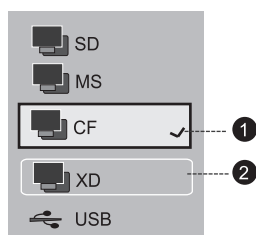

Available Selected Card Dialogue Box

- 1 The card has been selected
- 2 The card is being selected (not confirmed)

- Use the navigation keys to select a desired card and then press ENTER to confirm.
- The screen will display the main menu of the selected card.



MS and SD cards can't be inserted for use at the same time.

## MUSIC & VIDEO MODE

### Music&Video List

Upon entering the Main Menu, use the navigation keys to select a desired audio / video file and press ENTER to play, shown below.

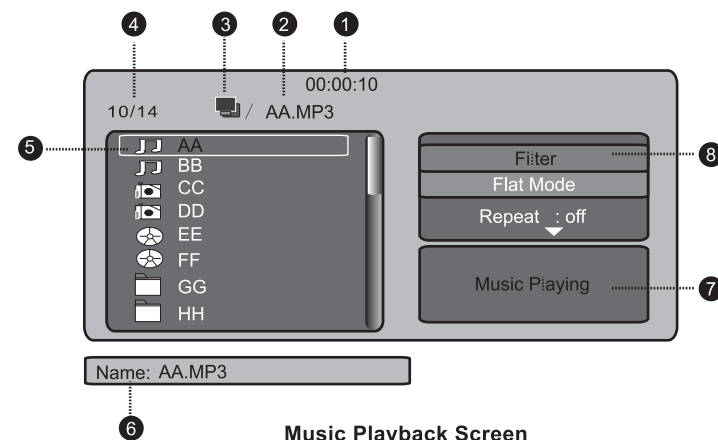

Music Playback Screen

- 1.Elapsed time
- 2.Filename of Current playback file
- 3.Current Disk Icon
- 4.Current File Number/Total Number of Files
- 5.Current Playback File
- 6.Name/Artist/Album/Year/Track/Comment of current playback file
- 7.Indicating that Music is Playing
- 8.Advanced setting(Filter/Flat Mode/Edit Mode)

### Advanced Settings

#### Filter

Use the Filter function to hide the unwanted Audio/Video/Photo files, Use the Navigation Keys to select and press Enter to confirm. After confirming the selection, the unwanted Audio/Video/Photo files will be hidden and stop playback ( if it's being played)

## MUSIC & VIDEO MODE

### Flat Mode

There're several custom settings in Flat Mode, use the Navigation keys to select Repeat or Mode, press ENTER to confirm a setting, see setting list below:

Repeat: Off/Single/Folder/All ( for Audio/Video Files)  
Mode : Normal/Shuffle/Music Intro (for Audio Files only)



when the Flat Mode is selected, the player will play all files as the settings. If it's not selected, the player will only play the audio files as the settings.

### Program

This functions helps you to choose your favourite Audio/Video/Photo files to play.

Make sure the Edit Mode is selected during program Editing. Otherwise some functions are not available.

- Use the Navigation Keys to select Edit mode in the advanced settings.
- Navigate to select any desired file in the main menu and press ENTER on it, the selected file will be framed, press again to cancel.
- Select and confirm Add To Program below the Edit Mode. (press ENTER to confirm)
- Select and confirm Program View below the Edit Mode to show the programmed files in the main menu box.
- To playback a programmed file, make sure the Edit mode is not selected, Select and confirm a file in the programmed file list, the programmed files will be played in sequence automatically.
- **To add more files in program mode:**  
Select and confirm Browser View below the Edit Mode to browse files in the Main Menu, follow the above steps to add more files.
- **To Cancel programmed files:**  
In the Programe Screen, Select and confirm the unwanted file, which will be clicked, and then select and confirm Clear Program below Edit mode. The file will be deleted from program file list .



In the Program Mode, Filter function is not available.

## MUSIC & VIDEO MODE

### Audio&Video Controls:

- To pause playback, press . To resume playback, press again  
(In Video Mode, you can also press ENTER to pause playback and press again to play.)
- To play the next file, press
- To play the previous file, press
- To stop playback, press
- To adjust the volume level, press VOL- or VOL+

### Audio Controls:

- To fast-forward through the current file, press and hold   
Forward: x 2 x 4 x 8 x 16
- To reverse through the current file, press and hold   
Reverse: x 2 x 4 x 8 x 16

### Video Controls:

After confirming an Video file, the screen will display its playback screen in full size.

- Press to toggle the screen ratio between 4:3 & 16:9.
- Press or icon for fast reverse or fast forward, each successive press will decrease or increase the speed by:

Reverse: x 2 x 4 x 8 x 16

Forward: x 2 x 4 x 8 x 16

- Press ENTER for normal playback.

### To Adjust Screen Brightness , Contrast & Color

- To adjust Brightness , Contrast & Color press and hold icon to show the dialogue box, use the Navigation Keys to adjust the value and confirm Close to save and exit, or confirm Reset to have the value back to the default settings.

## PHOTO MODE

### Photo List

Upon entering the Main Menu, use the navigation keys to select a desired photo file. The photo file selected screen shown below.

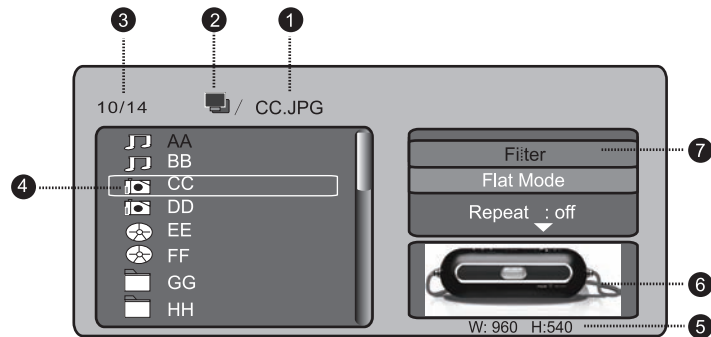

**Photo File Selected Screen**

1. Filename of selected file
2. Current Disk Icon
3. Current File Number/Total Number of Files
4. Current selected File
5. Photo dimension
6. Photo preview
7. Advanced settings (Filter/Flat Mode/Edit Mode)  
Refer to Audio&Video Mode section for details

### Photo View

Press ENTER on the selected photo file, your photo frame will display the photo in full-screen .

- To view the previous photo, press ◀, or press ▲ on the photo frame.
- To view the next photo, press ▶, or press ▼ on the photo frame.



*The Photo List will display supported Photo files, only.  
Your photo frame can display baseline JPEG files of up to 32 million pixels and 8MB in size.*

22

## PHOTO MODE

### **Zoom**

To increase the level of magnification, press ZOOM.

- Each successive press of ZOOM will change the level of magnification as shown below.

Q 1 ⇒ Q 2 ⇒ Q 3 ⇒ Q OFF

- To pan around the magnified picture, use the navigation keys.

### **Rotate**

To rotate the picture, press ANGLE.

- Each successive press of ROTATE will change the angle of rotation as shown below

90° ⇒ 180° ⇒ 270° ⇒ No Rotation

### **Screen size (Screen Ratio)**

To toggle the screensize between 4:3 (standard) and 16:9 (widescreen), press the SCREEN SIZE button on the remote (4:3 / 16:9).



To adjust the Photo View Mode , JPEG Interval Settings & Transition refer to SETUP section for operation details.

### **Slideshow**

The slideshow will start automatically while displaying photographs.

- To pause playback press ⏸, press again to resume.
- To display the previous / next photo, press ⏪ or ⏩.
- Press Menu to exit .  
Press ⏹ to stop slideshow transition, press again to restore.

23

## SETUP MENU

To adjust the settings and options of your digital photo frame, press SETUP. The Setup Menu appears on screen.

- Use the navigation keys to highlight and display option / sub-menus
- To confirm a selection, press ENTER
- To return to a previous menu level, press ◀
- To exit the Setup Menu, press SETUP or MENU

Please choose your desired settings as shown in the screens below. The options marked "✓" are selected.

### Language Options

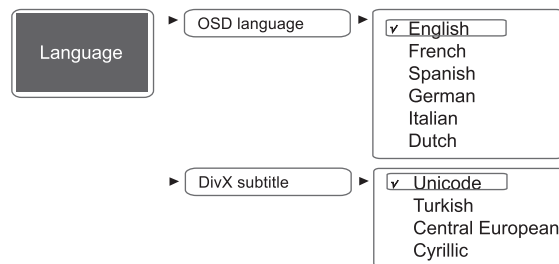

### Photo Options

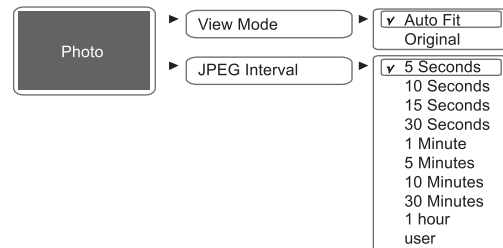

If USER is selected in JPEG Interval list, the interval of the photo slideshow will be operated manually.

24

## SETUP MENU

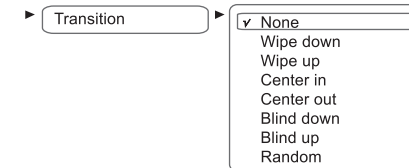

### Reset Options

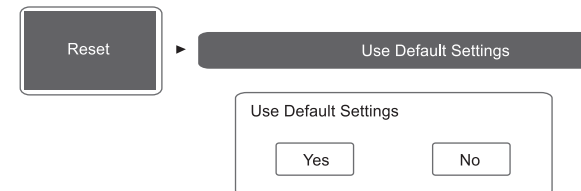

Confirm Yes on Use Default Settings dialogue box, the settings of the player will change to the default settings.

25

## CABLE CONNECTION

### Headphones

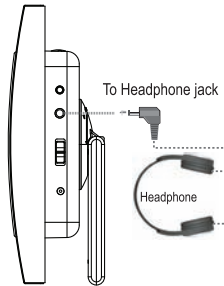

- Be sure that your unit is at low volume level before connecting the headphone.
- Increase the volume gradually to a comfortable listening level.

#### **CAUTION:**

*Hearing experts advise against the constant use of personal stereos played at high volume. Constant high volume use can lead to hearing loss. If you experience ringing in the ears or hearing loss, discontinue use and seek medical advice.*

### Audio-Only Output

To output audio only, use the AV connection but do not connect the Video cables.

## CABLE CONNECTION

To use your DP-767 to output audio and video to an external home theater system, use the connections diagrammed below.

### Composite Video

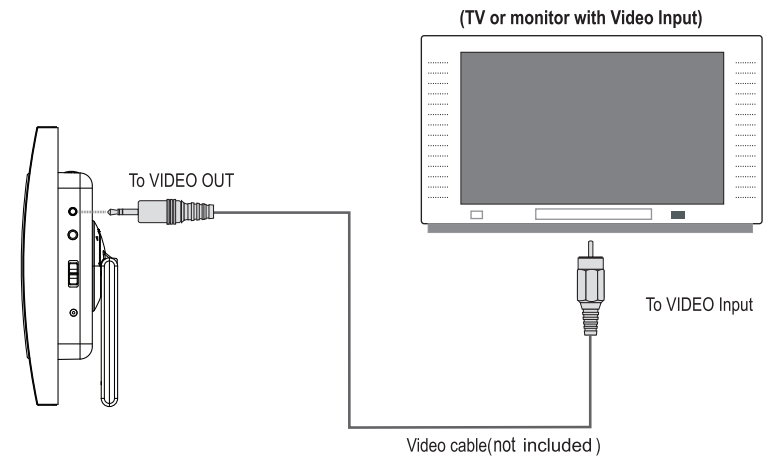

- NOTE:**
1. Refer to your TV's instruction manual for more guidance.
  2. Before connecting the Digital Photo Frame to a TV set, be sure to turn the power off and unplug both units from the wall outlet.

## INTERCHANGEABLE FACEPLATE

To affix a faceplate to your photo frame:

1. Attach the faceplate to the main unit and rotate the clips in the direction of the arrows at a  $\pm 90^\circ$  angle .
2. Now it has been affixed to the surface of the photo frame.

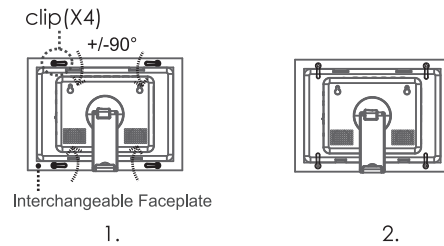

To detach the faceplate from your photo frame.

1. Rotate the clips in the direction of the arrows at a  $\pm 90^\circ$  angle .
2. Simply remove the main unit from the faceplate, the faceplate has been detached.

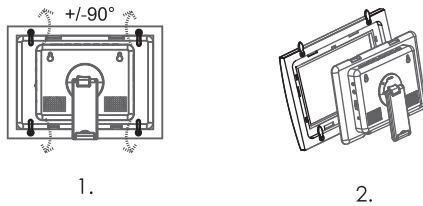

## FIRMWARE UPDATES

From time to time, COBY may release firmware updates to improve the performance of the DP-767 or to add additional features. Please check the COBY website periodically at [www.cobyusa.com](http://www.cobyusa.com) to see if new firmware has been released for your photo frame.





## SPECIFICATIONS

Display Type	7" Full-Color TFT LCD
Display Resolution	480 x 3(RGB) x 234
Memory	CF Card Slot SD/MMC Card Slot xD Card Slot MS Card Slot
Audio Format Support	MP3 (32 - 384kbps, CBR/VBR) WMA
Video Format Support	AVI (XviD) DIVX MPG MPEG
Photo Format Support	JPEG (8 MB)
USB Host	USB 2.0 High-Speed (device)
Audio Output	3.5mm Stereo / Headphone Integrated Stereo Speakers
Video Output	Composite Video
Power Supply	DC 12V, 1A 100-240V AC Adapter

*Specifications and manual are subject to change without prior notice.*

## Free Manuals Download Website

<http://myh66.com>

<http://usermanuals.us>

<http://www.somanuals.com>

<http://www.4manuals.cc>

<http://www.manual-lib.com>

<http://www.404manual.com>

<http://www.luxmanual.com>

<http://aubethermostatmanual.com>

Golf course search by state

<http://golfingnear.com>

Email search by domain

<http://emailbydomain.com>

Auto manuals search

<http://auto.somanuals.com>

TV manuals search

<http://tv.somanuals.com>