

- EN** Do not use the headphones while operating a motorised vehicle as it can pose a danger to other motorists, pedestrians or yourself.  
Be alert and careful when using the headphones outdoor.  
Do not listen with the headphones at excessive volume levels, prolonged exposure can cause hearing damage.
- FR** N'utilisez pas les écouteurs lorsque vous conduisez, car cela n'est pas sans risque pour votre sécurité, et celle des autres automobilistes et piétons.  
Soyez vigilant et prudent lorsque vous utilisez les écouteurs.  
N'utilisez pas les écouteurs des niveaux sonores excessifs; une exposition prolongée des niveaux sonores élevés peut en effet entraîner des dommages auditifs.
- ES** No utilice los auriculares mientras conduce, ya que constituyen un peligro para peatones, para otros conductores y para su propia persona.  
Utilice los auriculares en el exterior con precaución.  
No abuse del volumen. El uso de auriculares a un volumen elevado durante un periodo prolongado de tiempo puede causar problemas de oído.
- BP** Não use os fones de ouvido quando estiver dirigindo, pois isso pode representar um perigo para outros motoristas, pedestres ou para você mesmo.  
Tome cuidado ao usar os fones de ouvido ao ar livre.  
Não use os fones de ouvido em volume muito alto; a exposição prolongada pode causar danos auditivos.
- TR** Diğer taşıt sürücülerini, yayalar ve sizin için zehreli olabilir.  
İn, araç kullanırken kulaklıklar takmayın.  
Kulaklıklar dışarıda kullanırken daima tedikte ve dikkatli olun.  
Kulaklıklarla yüksek sesle müzik dinlemeyin; uzun süre yüksek sesle müzik dinlenmesi işitme kaybına yol açabilir.
- CT** 為了避免造成其他汽車駕駛人、行人或者你個人的安全，在開車時不要使用耳機。  
當在戶外使用耳機時，請注意及小心。  
不要長時間用耳機聆聽高音量的聲音，長時間暴露在高音量下，可能會引起聽覺損害。
- JP**
- CS**
- KR**

- Reorient or relocate the receiving antenna.
- Increase the separation between the equipment and receiver.
- Connect the equipment into an outlet on a circuit different from that to which the receiver is connected.
- Consult the dealer or an experienced radio/TV technician for help.

This device complies with part 15 of the FCC Rules. Operation is subject to the following two conditions:  
1. This device may not cause harmful interference, and  
2. This device must accept any interference received, including interference that may cause undesired operation.

**Caution**  
To comply with the limits of the Class B digital device, pursuant to Part 15 of the FCC Rules, this device must be installed with computer equipment certified to comply with Class B limits.  
All cables used to connect to the computer and peripherals must be shielded and grounded. Operation with non-certified computers or non-shielded cables may result in interference to radio or television reception.

**Modification**  
Any changes or modifications not expressly approved by the grantee of this device could void the user's authority to operate the device.

**State of California Proposition 65:**  
WARNING: Handling the cord(s) on this product may expose you to lead, a chemical known to the State of California to cause cancer and birth defects or other reproductive harm. Wash your hands after handling.

**Notice for Canada**  
This Class B digital apparatus complies with Canadian ICES-003.  
Cet appareil numérique de la classe B est conforme de la norme NMB-003 du Canada.

**Canadian Class B Statement**  
This digital device does not exceed the Class B limits for radio noise emissions from digital apparatus as set out in the interference-causing equipment standard entitled "Digital Apparatus," ICES-003 of the Department of Communications.

Cet appareil numérique respecte les limites de bruits radioélectriques applicables aux appareils numériques de Classe B prescrites dans la norme sur le matériel brouilleur: "Appareils Numériques," NMB-003 édictée par le ministre des Communications.

**MODIFICATION:**  
Any changes or modifications not expressly approved by the grantee of this device could void the user's authority to operate the device.  
Toute modification non approuvée explicitement par le fournisseur de licence de l'appareil peut entraîner l'annulation du droit de l'utilisateur d'utiliser l'appareil.

CREATIVE



CREATIVE  
AURVANA  
X-Fi

Noise-Canceling Headphones

AURVANA  
X-Fi

Noise-Canceling Headphones

P/No. : 03MZ031500000 Rev. A

**Declaration Of Conformity**  
Manufacturer / Importer's Name: Creative Labs, Inc.  
Manufacturer / Importer's Address: 1901 McCarthy Boulevard, Milpitas, CA, 95035 United States  
Tel: (408) 428-6600

declares under its sole responsibility that the product  
Trade Name: Creative Labs  
Model Numbers: Aurvana X-Fi

has been tested according to the FCC/CISPR22/97 requirement for class B devices and found compliant with the following standards:  
EMI/EMC: ANSI C63.4 2003, FCC Part 15 Subpart B Complies with Canadian ICES-003 Class B

This device complies with part 15 of the FCC Rules. Operation is subject to the following two conditions:  
1. This device may not cause harmful interference, and  
2. This device must accept any interference received, including interference that may cause undesirable operation.

Ce matériel est conforme de la section 15 des règles FCC. Son Fonctionnement est soumis aux deux conditions suivantes:  
1. Le matériel ne peut émettre d'interférences et  
2. Doit accepter toutes les interférences reçues. Y compris celles pouvant provoquer un fonctionnement indésirable.  
Compliance Manager  
Creative Labs, Inc.  
29 June, 2007

The following sections contain notices for various countries:

**Caution**  
This product is intended for use with FCC/CE certified computer equipment. Please check the equipment operating/installation manual and/or with the equipment manufacturer to verify/confirm if your equipment is suitable prior to the installation or use of the product.

**Notice for USA**  
FCC Part 15: This equipment has been tested and found to comply with the limits for a Class B digital device, pursuant to Part 15 of the FCC Rules. These limits are designed to provide reasonable protection against harmful interference in a residential installation. This equipment generates, uses and can radiate radio frequency energy and, if not installed and used in accordance with the instructions, may cause harmful interference to radio communications. However, there is no guarantee that interference will not occur in a particular installation. If this equipment does cause harmful interference to radio or television reception, which can be determined by turning the equipment off and on, the user is encouraged to try to correct the interference by one or more of the following measures:

- EN** Do not load batteries with polarities (+/-) reversed.  
Do not force batteries into the battery compartment.  
Do not short-circuit the battery with metallic objects such as key holders or jewellery. This may damage the battery and other electrical components.
- FR** N'introduisez pas de piles aux pôles (+/-) inversés.  
Ne forcez pas pour insérer les piles dans leur compartiment.  
Ne mettez pas les piles en court-circuit avec des objets métalliques tels que des porte-clés ou des bijoux. Cela pourrait endommager la pile et d'autres composants électriques.
- ES** No introduzca las pilas con las polaridades invertidas (+/-).  
No fuerce las pilas en el compartimento.  
No provoque un cortocircuito de la batería con objetos metálicos como llaveros o joyas. Esto podrá dañar la batería y a otros componentes eléctricos.
- BP** Não carregue pilhas com polaridades invertidas (+/-).  
Não use força para encaixar as pilhas no compartimento.  
Não provoque nenhum curto-circuito na bateria com objetos metálicos, como, por exemplo, porta-chaves ou jóias. Poderá danificar a bateria e outros componentes elétricos.
- TR** Pilleri, polaritelerini (+/-) ters olacak şekilde yerle tirmeyin.  
Pilleri, pil bölümüne sokmak için zorlamayın.  
Pilin, anahtar ya da takı gibi metal nesnelere temas etmeyin ya da diğer elektrikli nesnelere zarar görmesine neden olabilir.
- CT** 不要把電池的極性 (+/-) 弄反。  
不要把電池硬塞進電池匣。  
不要用金屬物件 (如鑰匙或金屬飾物) 使電池短路。這有可能損壞電池或其他的子物件。
- JP**
- CS** 裝電池時不要把極性 (+/-) 弄反。  
不要把電池強行裝入電池匣。  
不要用金屬物件 (如鑰匙或金屬飾物) 使電池短路。這會使電池和其他的電子元件損壞。
- KR**

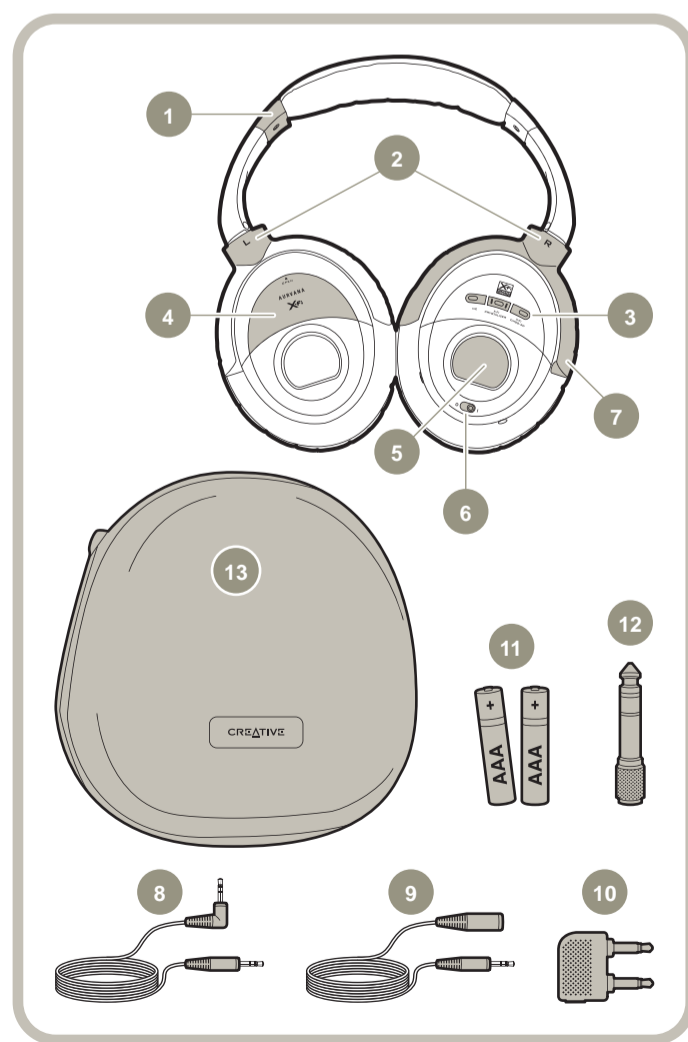

Congratulations on selecting Creative Aurvana X-Fi Headphones from Creative Labs. With advanced active noise canceling and enhanced with X-Fi features, you can significantly block out ambient noise while experiencing an exceptional listening experience.

- Package Contents**
- Adjustable headband.
  - Left (L) and right (R) markings.
  - Active Noise Cancellation and X-Fi enhancement controls. Push to activate - blue indicator lights up.
  - Battery compartment.
  - Acoustic grille housing a microphone for noise cancellation function.
  - Power on/off switch. Blue indicator lights up when powered on. It blinks when battery level is low. Power off to enjoy unprocessed audio in bypass mode.
  - Rotating earcups.
  - Detachable input cable. The L-shaped plug connects to your audio source.
  - Extension audio cable.
  - Airplane adapter.
  - 2 AAA alkaline batteries.
  - 6.3mm (1/4") adapter for connection to home stereo equipment.
  - Travel case.

**Using Your Headphones**

**Inserting and Replacing Batteries.**  
Tilt the left earcup flat to access the battery compartment.  
Slide the battery compartment door open and lift it up.  
Insert 2 AAA alkaline batteries. Follow the battery orientation as shown in the compartment.  
Plug in the detachable input cable. Connect the other end of the cable to your audio source. You can omit this step if you intend to use the headphones to just cancel out surrounding noise during air travel.

**Power on the headphones.**  
Locate the left (L) and right (R) markings before putting on the headphones. Adjust the headband height if necessary.  
Adjust the volume to a comfortable level.  
Caution: excessive volume level for a prolonged period can cause permanent hearing damage!  
Turn on either Noise Cancellation (NC), X-Fi Crystalizer or X-Fi CMSS-3D to enhance your listening experience. You can activate these concurrently.

Aurvana X-Fi makes use of advanced phase canceling to significantly reduce ambient noise while preserving the timbre and quality of the original source. X-Fi Crystalizer dramatically restores the quality of compressed audio tracks such as MP3 or poorly mastered CDs. X-Fi CMSS-3D delivers a more natural audio playback.

Note that the playback may sound unnatural if the audio source has been pre-processed with X-Fi or other audio enhancements when used with the headphones' X-Fi features. We recommend that you turn off any audio enhancements other than those on the headphones.

**Maintenance and Care**

- Replace batteries when the Power indicator blinks. You can still enjoy unprocessed audio playback by powering off the headphones (audio bypass mode).
- Wipe the headphones and earpads with a damp cloth regularly to keep the headphones in pristine condition.
- Fold and store the headphones in the supplied travel case when it is not in use for a long duration.

## Free Manuals Download Website

<http://myh66.com>

<http://usermanuals.us>

<http://www.somanuals.com>

<http://www.4manuals.cc>

<http://www.manual-lib.com>

<http://www.404manual.com>

<http://www.luxmanual.com>

<http://aubethermostatmanual.com>

Golf course search by state

<http://golfingnear.com>

Email search by domain

<http://emailbydomain.com>

Auto manuals search

<http://auto.somanuals.com>

TV manuals search

<http://tv.somanuals.com>