



THERMOPRO™ G3 ONE GALLON DIGITAL COFFEE BREWING SYSTEMS

MODELS: TP1S SINGLE, TP1T TWIN

The one gallon gourmet brewing solution.

Perfect for smaller operations, the ThermoPro™ One Gallon Coffee Brewing System provides easy-to-use precision brewing for consistently rich and robust gourmet flavor brew after brew.



ThermoPro TP1S with TXSG01 Server.



ThermoPro TP1T with TXSG01 Server.



One gallon airpots on CAR-4 Four Position Step-up Airpot Rack. (Airpots sold separately).

ThermoPro TP1T with TXSG01 Server (l) and TLXA01 Airpot (R). (Airpots sold separately).



ITEM NO

PROJECT

DATE

FEATURES AT A GLANCE

BREWING SYSTEM

- **Brew only what you need** — two pre-set buttons allow you to select between one gallon and half gallon at the touch of a button.
- **Easily Fine Tune Your Signature Flavor** — G3 systems offer complete control over time, volume, temperature and all brewer operating functions.
- **Enjoy Simplified Maintenance** — On-board self-diagnostics continually monitor the system, Intuitive error codes and service phone number are displayed in the uncommon event that service is required.
- **Quick Recovery provided by standard 220V/ single phase power** — Easily field convertible for higher wattage faster recovery.
- **Convenient hot water faucet for instant beverages and clean-up.**
- **Standard brew cones included.** Optional high capacity and gourmet brew cones.

SERVERS

- **Includes Curtis ThermoPro™ One-Gallon Servers without base (TXSG01)**
- **Gourmet flavor, freshness and temperature are locked in with stainless-steel vacuum-sealed servers.**
- **Quickly identify decaf brews** — Orange decaf label for TXSG01 server included.
- **Optimal ThermoPro™ One Gallon Airpot Server** — TLXA0101S000.
- **Remote service for 1, 2 or 3 stations is quick and convenient with remote stands.** (Sold separately)



TP1T Twin

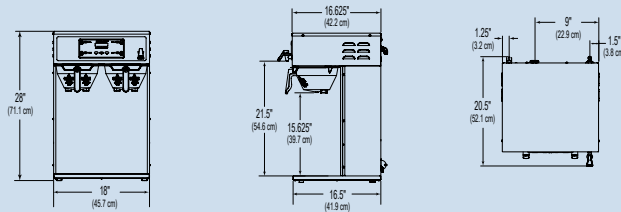

TP1S Single

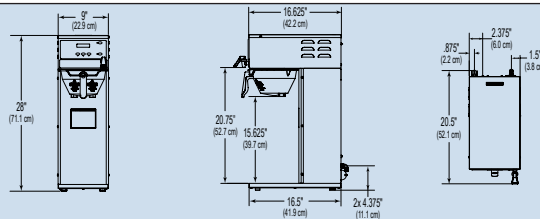

TSS1A Stand

TSS2A Stand

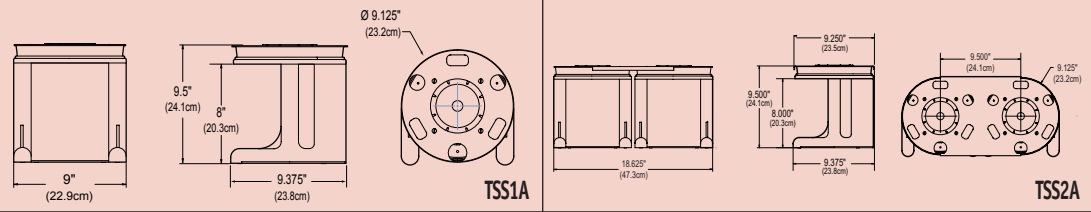

WS1 Wire Stand

TXSG01 Server

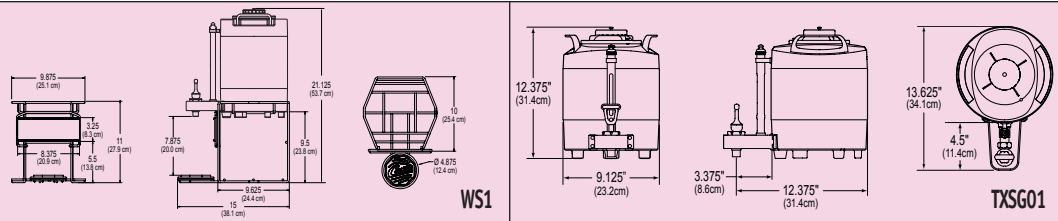

Specifications	Batch Brewing Selections	Finished Brewing Capacity	Dimensions (H x W x D)	Voltage	Power Requirements	Water Source	Shipping Wt (lbs. w/o server)	Cube (cu ft.)
TP1T Twin (includes 2 Servers)	2	2 Gal. (1 per side)	28" x 18" x 16.625"	220V/Single Phase 3 Wire Plus Ground	5100W/7600W*	3/8" Flare	61	8.6
TP1S Single (includes 2 Servers)	2	1 Gal.	27.875" x 9" x 16.625"	120V/220VAC 2W/3W + G	1650W/13.7A 2700W/15A	3/8" Flare	43	5.53
TSS1A Stand	N/A	N/A	9.5" x 9" x 9.375"	N/A	N/A	N/A	5	1.36
TSS2A Stand	N/A	N/A	9.5" x 18.625" x 9.375"	N/A	N/A	N/A	12	3.19
TXSG01 Server	N/A	1 Gal.	12.375" x 9.125" x 13.625"	N/A	N/A	N/A	17	2.04
WS1 Wire Stand	N/A	N/A	11" x 9.875" x 10"	N/A	N/A	N/A	4	1.09

* Field convertible to higher wattage.



TXSG01 Server on TSS1A Stand. TXSG01 Servers on TSS2A Stand. TXSG15 Server on WS1 Wire Stand. (For Tall Model)

Field Changeable Enhanced Recovery Circuitry

ThermoPro twin* units ship standard with a robust 5000 watts of recovery power. Should you have a higher rated circuit at the installation, a single connection change*** boosts the ThermoPro to a powerful 7500 watts providing enhanced recovery and brewing speed.

NOTE: *220VAC/Single Phase Models Only

*** Should be connected only by a qualified installation technician.



WILBUR CURTIS COMPANY, INC.
6913 Acco Street, Montebello, CA 90640-5403
Telephone: 800-421-6150 · 323-837-2300
Fax: 323-837-2406
www.wilburcurtis.com



Free Manuals Download Website

<http://myh66.com>

<http://usermanuals.us>

<http://www.somanuals.com>

<http://www.4manuals.cc>

<http://www.manual-lib.com>

<http://www.404manual.com>

<http://www.luxmanual.com>

<http://aubethermostatmanual.com>

Golf course search by state

<http://golfingnear.com>

Email search by domain

<http://emailbydomain.com>

Auto manuals search

<http://auto.somanuals.com>

TV manuals search

<http://tv.somanuals.com>