

SMT Power Inductor

SIQ73 Type

Features

- RoHS compliant.
- Magnetically shielded.
- Ideal for power source circuits, DC-DC converter, DC-AC inverters inductor applications.
- In addition to the standard versions shown here, customized inductors are available to meet your exact requirements.

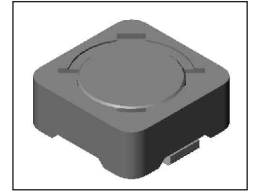

Mechanical Dimension:

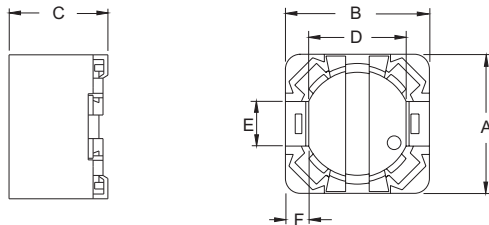

RECOMMENDED PAD PATTERNS

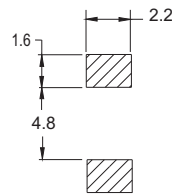

UNIT:mm/inch

A = 7.3±0.2 / 0.287±0.008

B = 7.3±0.2 / 0.287±0.008

C = 3.4 / 0.134 Max.

D = 5.0±0.2 / 0.197±0.008

E = 2.0±0.2 / 0.079±0.008

F = 1.1±0.2 / 0.043±0.008

Electrical Characteristics: 25°C, 100KHz, 0.1V for 0.45~6.8uH. 1KHz,1.0V for 10~1000uH.

PART NO.	L ¹ (uH)	DCR (Ω) MAX	Isat ² (A dc)	I _r ³ (A dc)
SIQ73A - R45	0.45	0.0076	9.00	9.00
SIQ73A - 1R0	1.00	0.012	6.50	5.70
SIQ73 - 1R2	1.20	0.013	4.70	4.70
SIQ73C - 2R0	2.00	0.024	7.30	4.00
SIQ73A - 2R2	2.10	0.0152 ± 20%	5.52	4.30
SIQ73C - 3R3	3.30	0.037	6.70	3.20
SIQ73 - 4R7	4.70	0.045	2.30	2.30
SIQ73C - 4R7	4.70	0.044	5.50	2.50
SIQ73C - 5R6	5.60	0.050	5.10	2.40
SIQ73C - 6R8	6.80	0.062	4.40	2.10
SIQ73 - 6R8	6.80	0.060	2.00	2.00
SIQ73 - 100	10.00	0.072	1.68	1.68
SIQ73 - 120	12.00	0.098	1.52	1.52
SIQ73 - 150	15.00	0.130	1.33	1.33
SIQ73 - 180	18.00	0.140	1.20	1.20
SIQ73 - 220	22.00	0.190	1.07	1.07
SIQ73 - 270	27.00	0.210	0.96	0.96
SIQ73 - 330	33.00	0.240	0.91	0.91
SIQ73 - 390	39.00	0.320	0.77	0.77
SIQ73 - 470	47.00	0.360	0.76	0.76
SIQ73 - 560	56.00	0.470	0.68	0.68
SIQ73 - 680	68.00	0.520	0.61	0.61
SIQ73 - 820	82.00	0.690	0.57	0.57
SIQ73 - 101	100.00	0.790	0.50	0.50
SIQ73 - 121	120.00	0.890	0.49	0.49
SIQ73 - 151	150.00	1.270	0.43	0.43
SIQ73 - 181	180.00	1.450	0.39	0.39
SIQ73 - 221	220.00	1.650	0.35	0.35
SIQ73 - 271	270.00	2.310	0.32	0.32
SIQ73 - 331	330.00	2.620	0.28	0.28
SIQ73 - 391	390.00	2.940	0.26	0.26
SIQ73 - 471	470.00	4.180	0.24	0.24
SIQ73 - 561	560.00	4.670	0.22	0.22
SIQ73 - 681	680.00	5.730	0.19	0.19
SIQ73 - 821	820.00	6.540	0.18	0.18
SIQ73 - 102	1000.00	9.440	0.16	0.16

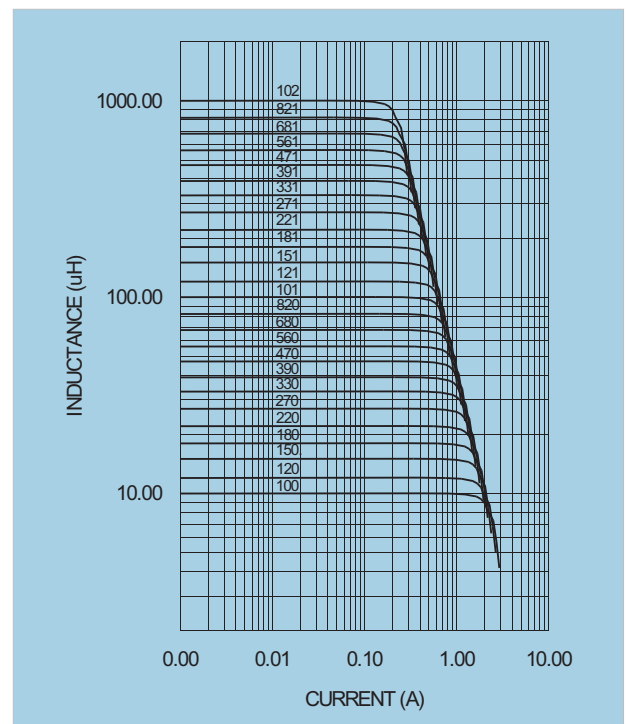

1. Tolerance of inductance: ±20% .
2. Isat is the DC current which cause the inductance drop less than 25% of its nominal inductance without current. (30% Typ. for SIQ73C)
3. Ir is the DC current which cause the surface temperature of the part increase less than 45°C.
4. Operating temperature: -20°C to 105°C (including self-temperature rise).



DELTA ELECTRONICS, INC.

(TAOYUAN PLANT CPBG) 252, SAN YING ROAD, KUEISAN INDUSTRIAL ZONE, TAOYUAN SHIEN, 333, TAIWAN, R.O.C.

TEL: 886-3-3591968; FAX: 886-3-3591991

<http://www.deltawww.com>

Free Manuals Download Website

<http://myh66.com>

<http://usermanuals.us>

<http://www.somanuals.com>

<http://www.4manuals.cc>

<http://www.manual-lib.com>

<http://www.404manual.com>

<http://www.luxmanual.com>

<http://aubethermostatmanual.com>

Golf course search by state

<http://golfingnear.com>

Email search by domain

<http://emailbydomain.com>

Auto manuals search

<http://auto.somanuals.com>

TV manuals search

<http://tv.somanuals.com>