

EMC[®]

GLOBAL MACHINERY COMPANY

INSTRUCTION MANUAL

3.75HP

**Petrol
Lawn
Mower**



2 YEAR
REPLACEMENT
WARRANTY

• Melbourne • Perth • Auckland • Hong Kong • Shanghai
• Taipei • New York • Verona • London • Paris

RL500
050826 E07 JJ

Contents

Warranty	2
Introduction	3
Description of symbols	3
Specifications	4
Safety rules for petrol lawn mowers	4
Unpacking	6
Contents of carton	6
Know your product	7
Assembly	8
Cutting height adjustment	8
Fueling	8
Checking the oil	9
Starting the engine	9
Stopping the engine	9
Mowing advice	9
Emptying the grass catcher bag	10
Replacing the blades	10
Maintenance	10



Full 2 Years Home Use Warranty

(Does not apply to the Briggs and Stratton engine)

Whilst every effort is made to ensure your complete satisfaction with this tool, occasionally, due to the mass manufacturing techniques, a tool may not live up to our required level of performance and you may need the assistance of our service department.

This product is warranted for a 2-year period for home domestic use from the date of the original purchase. If found to be defective in materials or workmanship, the tool or the offending faulty component will be replaced free of charge with another of the same item. A small freight charge may apply.

The warranty replacement unit is only made available by returning the tool to the place of purchase with a confirmed register receipt. Proof of purchase is essential. We reserve the right to reject any claim where the purchase cannot be verified.

This warranty does not include damage or defects to the tool caused by or resulting from abuse, accidents, alterations or commercial or business use.

It also does not cover any bonus accessories unless the tool is a GMC Platinum Professional model.

Please ensure that you store your receipt in a safe place. Conditions apply to the above warranty.

If you need direction of what constitutes a free of charge warranty claim, please review the guide given on the rear of the Receipt Holder. An indication is given as to the types of claim that are permissible, and those that are not.

Dear Customer

If you require any help with your product, whether it is a Warranty claim, spare part or user information, please phone our Help Line for an immediate response. Phone 1300 880 001 in Australia or 0800 445 721 in New Zealand.

Introduction

Your new GMC power tool will more than satisfy your expectations. It has been manufactured under stringent GMC Quality Standards to meet superior performance criteria.

You will find your new tool easy and safe to operate, and, with proper care, it will give you many years of dependable service.

CAUTION. Carefully read through this entire Instruction Manual before using your new GMC Power Tool. Take special care to heed the Cautions and Warnings.

Your GMC power tool has many features that will make your job faster and easier. Safety, performance, and dependability have been given top priority in the development of this tool, making it easy to maintain and operate.

Environmental protection



Recycle unwanted materials instead of disposing of them as waste. All tools, hoses and packaging should be sorted, taken to the local recycling centre and disposed of in an environmentally safe way.

Description of symbols

The rating plate on your tool may show symbols. These represent important information about the product or instructions on its use.



N380

Conforms to relevant standards for electromagnetic compatibility.



Wear hearing protection.

Wear eye protection.

Wear breathing protection.



Wear safety footwear.



Wear safety gloves.



Warning.



Read these instructions for use carefully.



Use at a distance of at least 15m from other people.



Thrown objects and rotating blades can cause severe injury.



Explosive material.

Extremely hot surface. Do not touch a hot muffler, gear box or cylinder, you may get burned. These parts get extremely hot from operation and remain hot for a short time after the unit is turned off.



Caution before carrying out any operation stop the engine and disconnect the spark plug cap.



Caution. Risk of hand and feet injuries

Specifications

Engine:	3.75HP, 4 Stroke
Speed:	0 - 3000min ⁻¹
Width of cut:	18" 460mm
Blades:	4 Swing back
Height adjustment:	10 Levels, 15-70mm
Grass catcher capacity:	60L
Equivalent Spark plugs:	CHAMPION RJ19LM DENSO W9LMR-US NGK BR2LM
Sound pressure value:	96dB(A)
Weight:	27kg

Safety rules for petrol lawn mowers

Training

- Read the instructions carefully. Get familiar with the controls and proper use of the equipment.
- Only use the lawn mower for the purpose for which it was designed, i.e. for cutting and collecting grass. Any other use can be hazardous, causing damage to the machine.
- Never allow children or people unfamiliar with these instructions to use the lawn mower. Local regulations may restrict the age of the operator.
- Never use the lawn mower:
 - When people, especially children, or pets are nearby.
 - If the operator has taken medicine or substances that can affect his ability to react and concentrate.
- Remember that the operator or user is responsible for accidents or hazards occurring to other people or their property.

Preparation

- While mowing, always wear sturdy footwear and long trousers. Do not operate the equipment when barefoot or wearing open sandals.

- Thoroughly inspect the area where the equipment is to be used and remove all objects which may be thrown by the machine or damage the cutter assembly and the engine (stones, sticks, metal wire, bones, etc.)
- **WARNING: DANGER!** Engine fuel is highly flammable:
 - Store fuel in containers specifically designed for this purpose.
 - Refuel using a funnel and outdoors only. Do not smoke while refuelling or whenever handling the fuel.
 - Add fuel before starting the engine. Never remove the cap of the fuel tank or add fuel while the engine is running or when the engine is hot.
 - If fuel is spilled, do not attempt to start the engine but move the machine away from the area of spillage and avoid creating any source of ignition until the fuel has evaporated and the vapour dispersed.
 - Replace all fuel tanks and containers caps securely.
- Substitute faulty silencers.
- Before use, always inspect the machine, especially the condition of the blades, and check that the screws and cutting assembly are not worn or damaged. Replace worn or damaged blades and screws in sets to preserve balance.
- Discharge openings must be guarded at all times. Do not remove the discharge guard or hold it up while mowing.
- It is advisable to wear suitable eye protection when operating the mower.

Operation

- Do not operate the engine in a confined space where dangerous carbon monoxide fumes can collect.
- Mow only in daylight or good artificial light.
- If possible, avoid operating the equipment in wet grass.
- Always be sure of your footing on slopes.
- Walk, never run and do not allow yourself to be pulled along by the lawn mower.

- Mow across the face of slopes, never up and down.
- Exercise extreme caution when changing direction on slopes.
- Do not mow on slopes of more than 20°.
- Exercise extreme caution when pulling the lawn- mower towards you.
- Stop the blade if the lawn mower has to be tilted for transportation when crossing surfaces other than grass, and when transporting the lawn mower to and from the area to be mowed.
- Never operate the lawn mower with defective guards, or without safety devices, such as the stoneguard and/or grass-catcher, in place.
- Do not change the engine governor settings or over speed the engine.
- On power-driven models, disengage the drive clutch before starting the engine.
- Start the engine carefully, following the instructions and keeping feet well away from the blade.
- Do not tilt the lawn mower when starting the engine. Start the engine on a flat surface that is free of obstacles and tall grass.
- Do not put hands or feet near or under rotating parts. Keep clear of the discharge opening at all times.
- Never pick up or carry a lawn mower while the engine is running.
- Stop the engine and disconnect the spark plug wire:
 - Before carrying out any work underneath the cutting deck or before unclogging the chute;
 - Before checking, cleaning or working on lawn mower;
 - After striking a foreign object. Inspect the lawn mower for damage and make repairs before restarting and operating the lawn mower;
 - If the lawn mower starts to vibrate abnormally (find

and remove the cause of the vibration immediately).

- Stop the engine:
 - Whenever you leave the lawn mower unattended. Remove the key from models with electric starters.
 - Before refuelling.
 - Every time you remove or replace the grass-catcher.
- Reduce the throttle before turning off the engine and turn the fuel off when you have finished mowing, following the instructions in the engine handbook.
- When mowing, always keep to a safe distance from the rotating blade. This distance is the length of the handle.
- Never cut grass while walking backwards.
- Stop the engine before pushing mower across gravel drives, walks or roads.

Maintenance and storage

- Keep all nuts, bolts and screws tight to be sure the equipment is in safe working condition. Regular maintenance is essential for safety and performance.
- Never store the equipment with fuel in the tank inside a building where vapour may reach a flame or a spark or a source of extreme heat.
- Allow the engine to cool before storing in an enclosed space.
- To reduce the fire hazard, keep the engine, exhaust silencer, battery compartment and fuel storage area free of grass, leaves, or excessive grease. Do not leave containers with grass cuttings in rooms.
- Check the stone-guard and grass-catcher frequently for wear and deterioration.
- If the fuel tank has to be drained, this should be done outdoors and when the engine is cool.
- Wear strong work gloves when removing and reassembling the blade.

- *Check the blade's balance after sharpening.*
- *For reasons of safety, do not use the equipment with worn or damaged parts. Parts are to be replaced and not repaired. Parts that are not of the same quality can damage the equipment and be dangerous for your safety.*
- *Whenever the machine is to be handled, transported or tilted you must:*
 - *wear strong working gloves;*
 - *grasp the machine at the points that offer a safe grip, taking account of the weight and its distribution.*
- *Damaged blades and worn bolts are major hazards.*

Unpacking

Due to modern mass production techniques, it is unlikely that your GMC Power Tool is faulty or that a part is missing. If you find anything wrong, do not operate the tool until the parts have been replaced or the fault has been rectified. Failure to do so could result in serious personal injury.

Contents of carton

- *Handle bar locking knobs, with bolts and washers x2*
- *Catcher*

Know your product

1. Handle bar
2. Lower handle
3. Throttle Lever
4. Discharge guard
5. Grass catcher bag
6. Height adjustment lever
7. Fuel tank cap
8. Oil filter cap
9. Recoil starter
10. Spark plug cap
11. Air filter
12. Primer bulb
13. Handle bar locking knob



Assembly

It is necessary to fit the lower handle (2), handle bar (1), and catcher (5) to the mower.

Attaching the grass catcher bag

1. Lift up the discharge guard (4) and hook the catcher onto the rod.
2. To remove the catcher, raise the discharge guard, grab the catcher by the handle and lift it off the bar.

Note. Always empty the catcher before it has reached maximum capacity, otherwise it will decrease the performance of the mower.



Attaching the Handles

It is necessary to attach both the lower handle and handle bars.

1. To attach the lower handle, first use a spanner to remove the 4 bolts.
2. Place the lower handle in position and replace the 4 bolts. Use the spanner to retighten the nuts.
3. To attach the handle bar, first remove the two handle bar locking knobs (14).

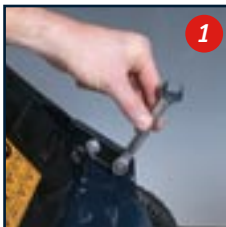

4. Position the handle bar over the lower handle and insert the two locking knobs, and tighten to secure the handles together.

Cutting height adjustment

The GMC mower has one lever to easily adjust the cutting height. There are 10 height settings.

1. To decrease the cutting height pull the height adjustment lever (6) out and move it up a notch, towards the handlebar.
2. To increase the cutting height pull the lever out and move it down a notch, towards the motor.

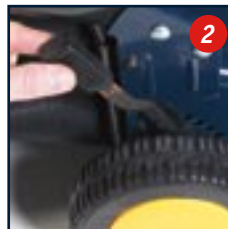

Note. If you are unsure of which cutting height to use, begin with a high setting and trial a small section of lawn, then check the appearance of the lawn. Then readjust if necessary.

Fuelling

Note. Use fresh unleaded petrol.

1. Unscrew the fuel tank cap (7) and pour the unleaded petrol into the tank with the aid of a funnel.
2. Fill the tank to approximately 2.5 cm below the lowest portion of the neck to allow for fuel expansion. Be careful not to over fill.
3. Be careful not to spill any petrol, if this happens, wipe the spill with a clean rag.
4. Start the engine at least three meters away from the area where the fuel tank has been filled in order to avoid the risk of fire.



WARNING. Never attempt to refuel the engine while it is running or still warm, allow it to cool before fuelling.

Note. For further information refer to the Fuel Recommendations section in the Briggs & Stratton instruction manual.

Checking the oil

Caution. The lawn mower is shipped without oil. Do not start your lawn mower before ensuring it has been filled with the right amount of correct grade oil. Refer to the oil recommendations section of the Briggs & Stratton instruction manual for this information.

1. Move the lawn mower to a level surface and clean around the oil filter cap (8).
2. Remove the oil filter cap with dipstick and wipe it with a clean cloth. Replace it and retighten the cap.
3. Remove the dipstick again and check the oil level, the oil should be at the full mark.
4. If oil is required add it slowly (the oil capacity is about 0.6 litre), do not over fill.
5. Retighten the oil filter cap firmly before starting the engine.

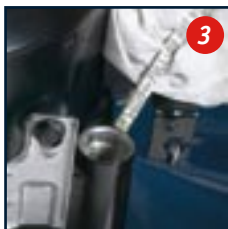

2. Push the primer bulb firmly 5 times (for initial starting) or 3 times (for engine starting there after).

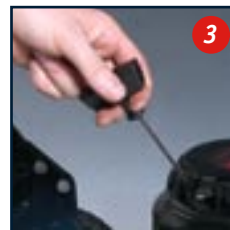
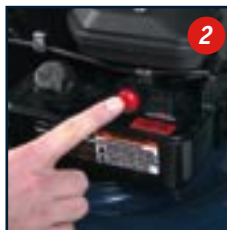

3. Pull the recoil starter (9) lightly until you feel resistance then pull quickly until the engine starts. Do not pull the cord with a jerk or release it until fully rewound.
4. Once the lawn mower has started and warmed up move the throttle lever to the Run position.

Stopping the engine

To stop the engine, move the throttle lever (3) to the stop position.

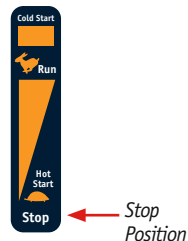
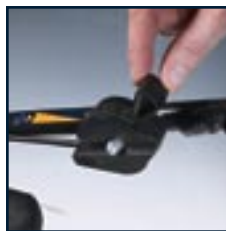

Starting the engine

Note. Before starting the mower check the oil and fuel levels.

1. Move the throttle lever (3) to the cold start position.

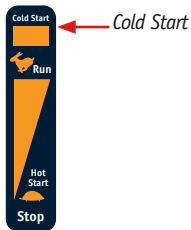

Mowing advice

1. It is recommended to use the fast throttle setting and keep the engine running at maximum speed. This will deliver the best cut. If the speed of the engine slows this could indicate the mower is being overloaded, by trying to cut too much grass. Try mowing a narrower strip, mowing slower or raise the cutting height.
2. Sharp blades cut cleanly and efficiently, if the blade is dull it will tear the grass. This will result in the ends turning brown. When the blades no longer cut cleanly either sharpen them or replace them.

3. To safely operate the mower ensure all four wheels are on the ground and be careful not to lose your footing or control of the mower. Be very careful when mowing uneven or rough ground. Keep a firm grip on the handle bar at all times, always walk, never run with the mower.
4. For healthy growth, grass should not be cut too short. This can cause damage to the grass and allow weeds to develop.
5. Vary your cutting pattern from week to week, this will help to prevent matting and graining of the grass.
6. Before checking a clogged mower deck stop the engine completely and disconnect the spark plug cover and then tilt the mower so the air filter side is facing upwards. Use a stick to clear any clogged material, never use your hands.
7. Mowing wet grass should be avoided. Wet grass will clog the mower deck and if it is slippery you may lose your footing.
8. Always mow across slopes not up and down them. Be extra careful if the grass is wet as this could cause you to slip and lose control of the mower.
9. If the ground is too dry, mowing will stir up a lot of dust which may clog the air filter. In these conditions it is recommended to water your lawn the day before mowing.
10. Use the side of the mower as a guide to cut close to large objects such as a fence or a wall. Be careful when mowing over obstacles embedded in the lawn such as sprinkler systems and paving, avoid anything that sticks up above the surface of the lawn.
11. Avoid mowing over loose stones, gravel and other landscaping material as this can be picked up by the mower and flung out causing serious personal injury.
12. If the blades do come into contact with something or the mower starts to vibrate stop the engine immediately, remove the spark plug cover and inspect to see if there is any damage.

Emptying the grass catcher bag

Note. Before making any adjustment or maintenance procedures to the mower ensure it is turned off and the spark plug cover is removed.

1. To remove the catcher, raise the discharge guard, grab the catcher by the handle and lift it off the bar.
2. Empty the grass from the catcher by holding it vertical, shake it if necessary to dislodge the full contents.

Grass catcher maintenance

Warning. Check the catcher bag frequently for damage or wear, and replace it if worn.

The fabric grass catcher requires air to flow through the fabric for effective grass collection.

Wash it if necessary to restore the open mesh in the fabric.

Do not leave the fabric bag in direct sunlight, prolonged sun exposure can cause permanent breakdown of the material.

Do not leave clippings in the catcher for extended periods.

Replacing the blades

Note. Before making any adjustment or maintenance procedures to the mower ensure it is turned off and the spark plug cover is removed.

Note. Wear heavy gloves to protect your hands.

1. Tilt the mower back so the spark plug is facing up.



2. Remove the blade disc with a spanner to remove the central blade bolt first.
3. Remove all 4 single blades including the washer and nuts.

4. Clean dirt and grass from around the blade mounting area.

5. Replace all 4 blades to ensure a smooth even cut.
By replacing the washer, then the half washer, then the nut securing the blade firmly, (25 - 30Nm) repeat this for the other 3 blades.

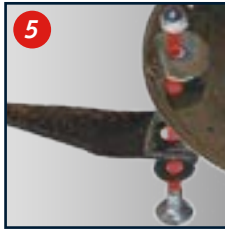

6. Replace the blade disc and retighten the central blade bolt tightly (50 - 59Nm).

Note. Use a wooden block to stop the blade from turning. The 4 blades should be tightened fully but check to ensure they can still swing back if they were to hit a solid object.

Where required tighten the bolts with a torque wrench, the centre disc blade bolt torque: 50 - 59Nm and the four blades torque: 25 - 30Nm.

If you do not have a torque wrench ask a mower service dealer to tighten the blade bolts before you use the mower.

WARNING. If the blade bolts are not tightened correctly they could loosen and/or come out and it would be possible for the blades to fly off while you are operating the mower.

Maintenance

For all maintenance information refer to the Briggs & Stratton instruction manual.

Carefully read the entire Instruction Manual before using this product.

**Before returning this product for a
Warranty Claim or any other reason
Please Call 1300 880 001 (Australia)
or 0800 445 721 (New Zealand)**

**When you make your call, please have
the following information at hand:**

- **GMC Product Type**
- **GMC Product Code**

A GMC Service Engineer will take your call and, in most cases, will be able to solve your problem over the phone.

You are welcome to use this phone-in service to make suggestions or give comments about any GMC product.

With continuing product development changes may have occurred which render the product received slightly different to that shown in this instruction manual. The manufacturer reserves the right to change specifications without notice. Note: Specifications may differ from country to country.



The GMC 777 Helpline operates from 7am to 7pm, 7 days a week (EST). This allows you to contact GMC directly with any queries and technical questions you have regarding our products.

GMC
GLOBAL MACHINERY COMPANY

45-55 South Centre Road
Melbourne Airport
Victoria, Australia 3045

Tel: (03) 8346 1100 Fax: (03) 8346 1200



Save this Manual for future reference.

Free Manuals Download Website

<http://myh66.com>

<http://usermanuals.us>

<http://www.somanuals.com>

<http://www.4manuals.cc>

<http://www.manual-lib.com>

<http://www.404manual.com>

<http://www.luxmanual.com>

<http://aubethermostatmanual.com>

Golf course search by state

<http://golfingnear.com>

Email search by domain

<http://emailbydomain.com>

Auto manuals search

<http://auto.somanuals.com>

TV manuals search

<http://tv.somanuals.com>